

Support Units - Fixed Side, Square <Cost Reduction>

Economy / Radial Bearing Type

Fixed Side Economy

(Economical, for Intermediate and Low Speed Applications)



Component Details

Number	Part Name	Quantity
①	Bearing Housing	1
②	Japanese made angular contact bearing Grade 0	1 Set
③	Cover	1
④	Oil Seal	2
⑤	Collar	2
⑥	Bearing Nut (with Set Piece)	1

Do not disassemble the fixed side main body ①, ②, ③ and ④ as they must remain assembled.

Type	M Material	S Surface Treatment
①③	⑤⑥	①③⑤⑥
BSWE	EN	Black Oxide
BSWEM	1.1191 Equiv.	Electroless Nickel Plating
BSWER	EN 1.0038 Equiv.	LTBC Plating

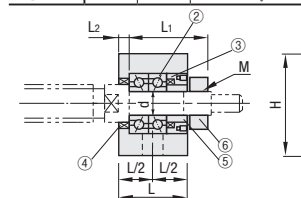

BSWER bearing is filled with low dust generation grease.

For No.10S, the I.D. of oil seal is smaller than the previous No.10S version.

When used together with a MISUMI ball screw, there is one support unit accessory collar spare.

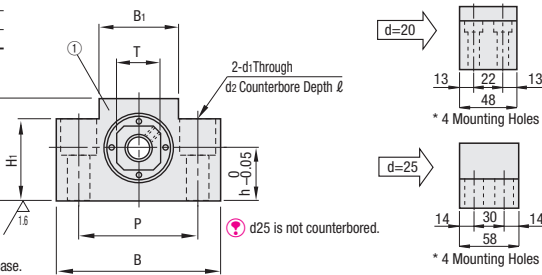

Part Number	Type	No.	d	L	L ₁	L ₂	B	H	h	B ₁	H ₁	P	d ₁	d ₂	ℓ	M (Fine)	T	Oil Seal Applicable Shaft Dia.	BSWE Unit Price 1 ~ 10 pc (s).	BSWEM Unit Price 1 ~ 10 pc (s).	BSWER Unit Price 1 ~ 10 pc (s).
BSWE BSWEM BSWER	1022	10	10				40	22		32						M10x1.0	17	14			
	10S	10	27	29.5	6	70	43	25		36	35	52	9	14	11			12			
	1223	12					41	23		33						M12x1.0	19	15			
	12	12					43	25		35											
	1526	15	29	38	5	80	*48	26		41	38	60	11	17	15	M15x1.0	22	20			
	1528	15					*50	28		40											
	15	15	20	48	52	10	95	58	*30	56	45	75				M20x1.0	30	25			
	20	20	25	58	59	14	105	68		66	25	85	11	-	-	M25x1.5	35	31			
	25	25																			
	25	25																			

* When No.=15, H dimension is taller than the Standard (P.761) by 2mm.

* Take care in combining No.20 with Ball Screw BSSZ(K)2510, BSSR(K)2510 or BSST2510. The ball screw nut may come in contact with the bottom surfaces.



For details of Bearings in addition to mounting interface accuracies of Support Units, Included Collar and Bearing Nut, see P.759

For Combination of Ball Screws and Support Units, see P.756

LTBC Plating products are filled with low dust generation grease for cleanrooms.

Fixed Side Radial Bearing Type

(Economical, for Low Speed Applications)



Component Details

Number	Part Name	Quantity
①	Bearing Housing	1
②	Japanese made radial bearing	1 Set
③	Cover	1
④	Oil Seal	1
⑤	Collar	2
⑥	Bearing Nut (with Set Piece)	1

Oil Seal ④ is not included in d=6.

Do not disassemble the fixed side main body ①, ②, ③ and ④, as they must remain assembled.

For No.8S and 10S, the I.D. of oil seal is smaller than the previous No.8S and No.10S versions.

Type	M Material	S Surface Treatment
①③	⑤⑥	①③⑤⑥
BSWZ	EN 1.1191 Equiv.	Black Oxide
BSWZM	EN 1.0038 Equiv.	Electroless Nickel Plating

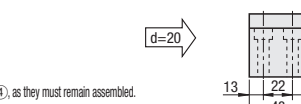
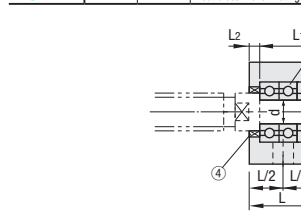

It is preloaded to bear the thrust load. Keep rotational speed within 3,000rpm.

When used together with a MISUMI ball screw, there is one support unit accessory collar spare.

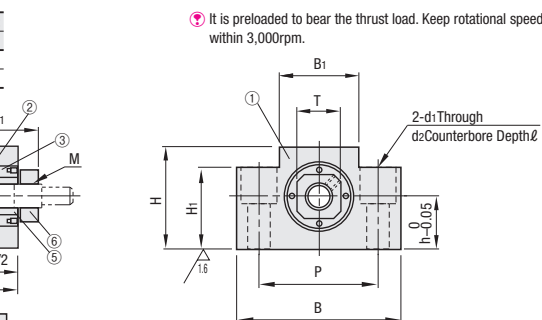

Part Number	Type	No.	d	L	L ₁	L ₂	B	H	h	B ₁	H ₁	P	d ₁	d ₂	ℓ	M (Fine)	T	Oil Seal Applicable Shaft Dia.	BSWZ Unit Price 1 ~ 10 pc (s).	BSWZM Unit Price 1 ~ 10 pc (s).
BSWZ BSWZM	6	6	6	20	22.5	3.5	42	25	13	18	20	30	5.5	9.5		M6x0.75	12	-		
	8S	8	8	23	26	4	52	32	17	25	26	38	6.6	11		M8x1.0	14	10		
	8	8																11.5		
	1022	10					40	22		32						M10x1.0	17	14		
	10S	10	27	29.5	6	70	43	25		36	35	52	9	14	11			12		
	1223	12					41	23		33						M12x1.0	19	15		
	12	12					43	25		35										
	1526	15	29	38	5	80	*48	26		41	38	60	11	17	15	M15x1.0	22	20		
	1528	15					*50	28		40										
	15	15	20	48	52	10	95	58	*30	56	45	75				M20x1.0	30	25		

* When No.=15, H dimension is taller than Standard by 2mm.

* Take care in combining No.20 with Ball Screw BSSZ (K) 2510, BSSR (K) 2510 or BSST2510. The ball screw nut may come in contact with the bottom surfaces.



For details of Bearings in addition to mounting interface accuracies of Support Units, Included Collar and Bearing Nut, see P.759

For Combination of Ball Screws and Support Units, see P.756

Support Units - Fixed Side, Round <Cost Reduction>

Economy / Radial Bearing Type

Fixed Side Economy

(Economical, for Intermediate and Low Speed Applications)



Component Details

Number	Part Name	Quantity
①	Bearing Housing	1
②	Japanese made angular contact bearing Grade 0	1 Set
③	Cover	1
④	Oil Seal	2
⑤	Collar	2
⑥	Bearing Nut (with Set Piece)	1

Do not disassemble the fixed side main body ①, ②, ③ and ④ as they must remain assembled.

BSWER bearing is filled with low dust generation grease.

When used together with a MISUMI ball screw, there is one support unit accessory collar spare.

Type	M Material	S Surface Treatment
①③	⑤⑥	①③⑤⑥
BRWE	EN	Black Oxide
BRWEM	1.1191 Equiv.	Electroless Nickel Plating
BRWER	EN 1.0038 Equiv.	LTBC Plating

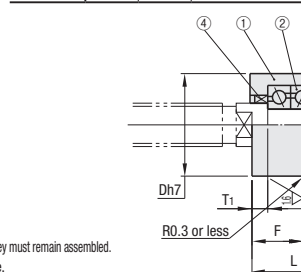

For No.10S, the I.D. of oil seal is smaller than the previous No.10S version.

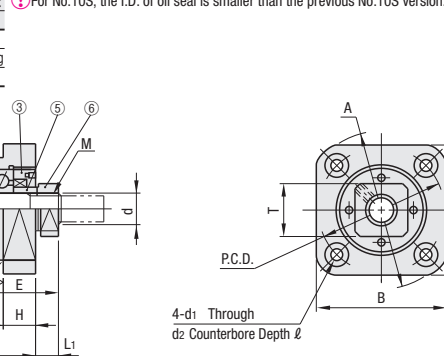

Part Number	Type	No.	d	L	H	F	E	D	A	P.C.D.	B	L ₁	T ₁	d ₁	d ₂	ℓ	M (Fine)	T	Oil Seal Applicable Shaft Dia.	BRWE Unit Price 1 ~ 10 pc (s).	BRWEM Unit Price 1 ~ 10 pc (s).	BRWER Unit Price 1 ~ 10 pc (s).
BRWE BRWEM BRWER	10S	10	10	26	10	16	29.5	34	52	42	42	8.5	5	4.5	8	4.5	M10x1.0	17	12			
	10	10																	14			
	12	12						36	54	44	44						M12x1.0	19	15			
	15	15	30	13	17	38	40	63	50	52		14	6	5.5	9.5	5.5	M15x1.0	22	20			
	20	20	48	18	30	52	57	85	70	68			10	6.6	11	6.5	M20x1.0	30	25			
	25	25	54	24	30	59	63	98	80	79			15	10	9	15	8.5	M25x1.5	35	31		

Fixed Side Radial Bearing Type

(Economical, for Low Speed Applications)



Component Details

Number	Part Name	Quantity
①	Bearing Housing	1
②	Japanese made radial bearing	1 Set
③	Cover	1
④	Oil Seal	1
⑤	Collar	2
⑥	Bearing Nut (with Set Piece)	1

Do not disassemble the fixed side main body ①, ②, ③ and ④, as they must remain assembled.

When used together with a MISUMI ball screw, there is one support unit accessory collar spare.

Type	M Material	S Surface Treatment
①③	⑤⑥	①③⑤⑥
BRWZ	EN 1.1191 Equiv.	Black Oxide
BRWZM	EN 1.0038 Equiv.	Electroless Nickel Plating

Oil Seal ④ is not included in d=6.

For No.8S and 10S, the I.D. of oil seal is smaller than the previous No.8S and No.10S versions.

It is preloaded to bear the thrust load. Keep rotational speed within 3,000rpm.

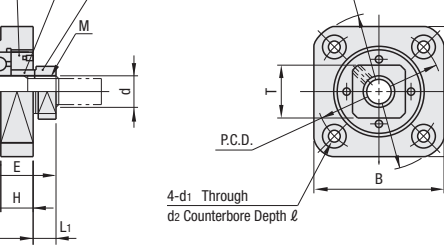
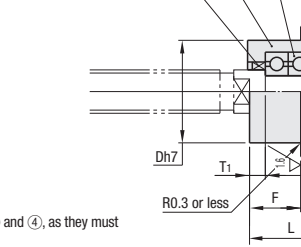

Part Number	Type	No.	d	L	H	F	E	D	A	P.C.D.	B	L ₁	T ₁	d ₁	d ₂	ℓ	M (Fine)	T	Oil Seal Applicable Shaft Dia.	BRWZ Unit Price 1 ~ 10 pc (s).	BRWZM Unit Price 1 ~ 10 pc (s).
BRWZ BRWZM	6	6	6	20	7	13	22.5	22	35	28	28	6	3.5	2.9	5.5	3.5	M6x0.75	12	-		
	8S	8	8	23	9	14	26	28	43	35	35	7	4	3.4	6.5	4	M8x1.0	14	10		
	8	8																	11.5		
	1022	10					40	22		32							M10x1.0	17	12		
	10S	10	26	10	16	29.5		36	54	44	44	8.5	5	4.5	8	4.5	M12x1.0	19	15		
	12	12															M15x1.0	22	20		
	15	15	30	13	17	38	40	63	50	52		14	6	5.5	9.5	5.5	M20x1.0	30	25		
	20	20	48	18	30	52	57	85	70	68			10	6.6	11	6.5					



For details of Bearings in addition to mounting interface accuracies of Support Units, Included Collar and Bearing Nut, see P.759