

# Chain Guides with Steel Frame / Chain Guides

L Dimension Selectable / Configurable

■Features: By passing a chain through this type of guide, conveyance is provided with little dust/noise.

## Chain Guides with Steel Frame

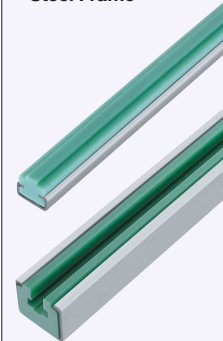

| Type                                      |         |  |         | Material                                 |                    |
|---|---------|--|---------|--|--------------------|
| L Dimension Selectable w/o Hole Machining |         | L Dimension Configurable with Hole Machining |         |  |                    |
| Raised Track                              | Channel | Raised Track                                 | Channel | Guide Rail                               | Steel Frame        |
| GDTC                                      | GDCC    | LGTC   | LGCC    | Ultra High-Molecular-Weight Polyethylene | Steel (Galvanized) |
| GDTS                                      | GDCS    | LGTS   | LGCS    |  | Stainless Steel    |

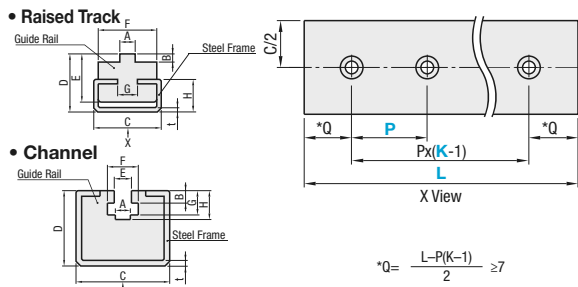

## Hole Machining Shape for Raised Track

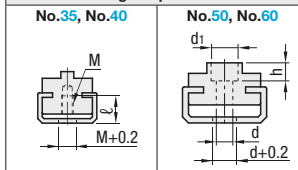

## Hole Machining Shape for Channel

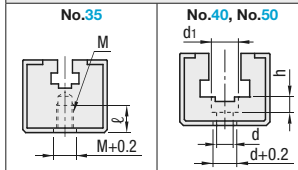

## L Dimension Selectable w/o Hole Machining

| Part Number  |     | L Length Selection<br>(mm) | A    | B    | C    | D    | E    | F    | G    | H    | t    | Mass<br>(kg/m) | Unit Price |       |        |            |       |        |  |  |  |
|--|-----|----------------------------|------|------|------|------|------|------|------|------|------|----------------|------------|-------|--------|------------|-------|--------|--|--|--|
| Type   | No. |                            |      |      |      |      |      |      |      |      |      |                | GDTC, GDCC |       |        | GDTS, GDCS |       |        |  |  |  |
|  |     |                            |      |      |      |      |      |      |      |      |      |                | L=450      | L=950 | L=2000 | L=450      | L=950 | L=2000 |  |  |  |
| Raised Track<br>GDTC (Steel)<br>GDTS (Stainless Steel) | 35  | 450                        | 4.4  | 2.3  | 20   | 17   | 14   | 17   | 10   | 10   | 1.5  | 0.67           |            |       |        |            |       |        |  |  |  |
|  | 40  | 950                        | 7.4  | 2.4  |      |      |      |      |      |      |      | 0.69           |            |       |        |            |       |        |  |  |  |
|  | 50  | 2000                       | 8.8  | 2.8  | 0.69 |      |      |      |      |      |      |                |            |       |        |            |       |        |  |  |  |
|  | 60  |                            | 11.8 | 3.5  | 28   | 20   | 24   | 14   | 12   | 2    | 1.12 |                |            |       |        |            |       |        |  |  |  |
| Channel<br>GDCC (Steel)<br>GDCCS (Stainless Steel)     | 35  | 450                        | 4.6  | 4.3  | 30   | 24   | 5.3  | 9.9  | 7.9  | 9.3  | 1.5  | 1.46           |            |       |        |            |       |        |  |  |  |
|  | 40  | 950                        | 5.1  | 7.4  |      |      | 8.4  | 13.2 | 11.7 | 13.7 |      | 1.40           |            |       |        |            |       |        |  |  |  |
|  | 50  | 2000                       | 6.4  | 8.9  | 10.7 | 16.5 | 14.5 | 16.2 | 1.34 |      |      |                |            |       |        |            |       |        |  |  |  |
|  | 60  |                            | 7.4  | 11.7 | 12.4 | 19.8 | 18.5 | 20.6 | 1.28 |      |      |                |            |       |        |            |       |        |  |  |  |

## L Dimension Configurable with Hole Machining

| Part Number  |     | L              | K                                   | P Hole Pitch  | A    | B    | C  | D  | E    | F    | G    | H    | t   | M  | ℓ   | d   | d1  | h | Mass (kg/m) |
|--|-----|----------------|-------------------------------------|---------------|------|------|----|----|------|------|------|------|-----|----|-----|-----|-----|---|-------------|
| Type   | No. | 10mm Increment | Number of Holes                     | 5mm Increment |      |      |    |    |      |      |      |      |     |    |     |     |     |   |             |
| Raised Track<br>LGTC (Steel)<br>LGTS (Stainless Steel) | 35  | 200~2000       | 0~10<br>Hole=1 cannot be specified. | 50~500        | 4.4  | 2.3  | 20 | 17 | 14   | 17   | 10   | 10   | 1.5 | M4 | 6   | -   | -   | - | 0.67        |
|  | 40  |                |                                     |               | 7.4  | 2.4  |    |    |      |      |      |      |     | M5 | 7.5 | -   | -   | - | 0.69        |
|  | 50  |                |                                     |               | 8.8  | 2.8  | 28 | 20 | 24   | 14   | 12   | 2    | 2   | -  | -   | 4.5 | 7.5 | 5 | 0.69        |
|  | 60  |                |                                     |               | 11.8 | 3.5  |    |    |      |      |      |      |     | M6 | 9   | -   | -   | 6 | 1.12        |
| Channel<br>LGCC (Steel)<br>LGCS (Stainless Steel)      | 35  | 200~2000       | 0~10<br>Hole=1 cannot be specified. | 50~500        | 4.6  | 4.3  | 30 | 24 | 5.3  | 9.9  | 7.9  | 9.3  | 1.5 | -  | -   | 4.5 | 7.5 | 5 | 1.46        |
|  | 40  |                |                                     |               | 5.1  | 7.4  |    |    |      |      |      |      |     | -  | -   | 4.5 | 7.5 | 5 | 1.40        |
|  | 50  |                |                                     |               | 6.4  | 8.9  | 30 | 24 | 10.7 | 16.5 | 14.5 | 16.2 | 1.5 | -  | -   | 5.5 | 9   | 6 | 1.34        |
|  | 60  |                |                                     |               | 7.4  | 11.7 |    |    |      |      |      |      |     | -  | -   | -   | -   | 6 | 1.28        |

⚠ P selection is unnecessary when Number of hole is 0. ⚠ Hole machining is not applicable to Channel No. 60.

⚠ Ultra High-Molecular-Weight Polyethylene may change in dimensions as its stretch rate changes by temperature.

|                  |             |   |      |   |    |   |      |
|------------------|-------------|---|------|---|----|---|------|
| Ordering Example | Part Number | - | L    | - | K  | - | P    |
|                  | GDCC50      | - | 450  | - | K8 | - | P100 |
|                  | LGTC40      | - | 860  | - | K8 | - | P100 |
|                  | LGCS60      | - | 1600 | - | K0 | - |      |

| No. |  | Body Price |           |           |            |             |      | Hole Machining Charge (Body Price +) |
|-----|--|------------|-----------|-----------|------------|-------------|------|--------------------------------------|
|     |  | LGTC       | L=200~450 | L=460~950 | L=960~1400 | L=1410~2000 | LGTS |                                      |
| 35  |  |            |           |           |            |             |      | Number of Holes x200                 |
| 40  |  |            |           |           |            |             |      |                                      |
| 50  |  |            |           |           |            |             |      |                                      |
| 60  |  |            |           |           |            |             |      |                                      |
| No. |  | Body Price |           |           |            |             |      | Hole Machining Charge (Body Price +) |
|     |  | LGCC       | L=200~450 | L=460~950 | L=960~1400 | L=1410~2000 | LGCS |                                      |
| 35  |  |            |           |           |            |             |      | Number of Holes x200                 |
| 40  |  |            |           |           |            |             |      |                                      |
| 50  |  |            |           |           |            |             |      |                                      |
| 60  |  |            |           |           |            |             |      |                                      |

## Raised Track, Channel

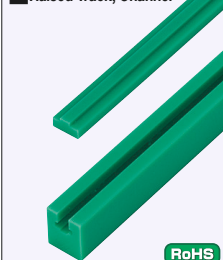

| Type         |      | Material                                 |
|--------------|------|--|
| Raised Track | GDTC | Ultra High-Molecular-Weight Polyethylene |
| Channel      | GDCC |  |

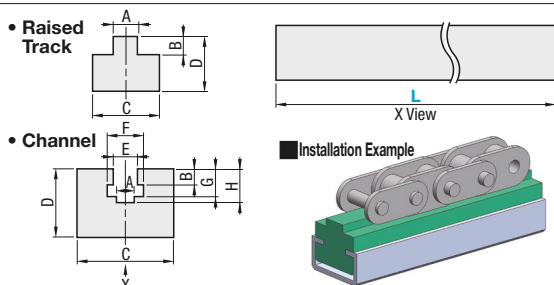

## L Dimension Selectable Type

| Part Number         |     | L Length Selection (mm) |  | A    | B    | C  | D  | E    | F    | G    | H    | t | Mass (kg/m) | Unit Price |       |        |
|---------------------|-----|-------------------------|--|------|------|----|----|------|------|------|------|---|-------------|------------|-------|--------|
| Type                | No. |                         |  |      |      |    |    |      |      |      |      |   |             | L=450      | L=950 | L=2000 |
| Raised Track<br>GDT | 40  | 450                     |  | 7.4  | 2.4  | 20 | 10 | -    | -    | -    | -    | - | 0.16        |            |       |        |
|                     | 50  | 950                     |  | 8.8  | 2.8  |    |    |      |      |      |      |   | 0.16        |            |       |        |
|                     | 60  | 2000                    |  | 11.8 | 3.5  | 25 |    |      |      |      |      |   | 0.36        |            |       |        |
| Channel<br>GDC      | 40  | 450                     |  | 5.1  | 7.4  | 25 | 30 | 8.4  | 13.2 | 11.7 | 13.7 |   | 0.58        |            |       |        |
|                     | 50  | 950                     |  | 6.4  | 8.9  | 30 | 35 | 10.7 | 16.5 | 14.5 | 16.2 |   | 0.8         |            |       |        |
|                     | 60  | 2000                    |  | 7.4  | 11.7 | 35 | 40 | 12.4 | 19.8 | 18.5 | 20.6 |   | 1.04        |            |       |        |

⚠ Ultra High-Molecular-Weight Polyethylene may change in dimensions as its stretch rate changes by temperature.

|                  |             |   |      |
|------------------|-------------|---|------|
| Ordering Example | Part Number | - | L    |
|                  | GDT50       | - | 450  |
|                  | GDC60       | - | 2000 |

# Flanged Chain Guides / Steel Chain Guides

L Dimension Selectable

■Features: This type of chain guide can be installed just by screw-tightening its flange through the mounting hole.

## Flanged

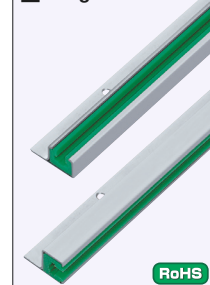

| Type                   |          | Material                                 |                    |
|------------------------|----------|--|--------------------|
| L Dimension Selectable |          |  |                    |
| Side Mount             | Up Mount | Guide Rail                               | Steel Frame        |
| GDYC                   | GDRC     | Ultra High-Molecular-Weight Polyethylene | Steel (Galvanized) |
| GDYS                   | GDRS     |  | Stainless Steel    |

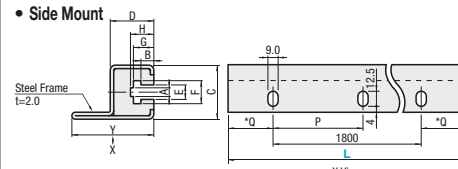

⚠ Upon existing stock is depleted, the flange part on the steel frame will be changed from Folded type to Welded Type. Note that this new type is equivalent to the conventional type, but has some traces of welding.

⚠ Channel can be pulled out of Steel Frame.

## L Dimension Selectable

| Part Number  |     | L Length (mm) |    | K               | P          | A   | B    | C  | D  | E    | F    | G    | H    | W  | Y  | Mass (kg/m) | Unit Price |           |
|--|-----|---------------|----|-----------------|------------|-----|------|----|----|------|------|------|------|----|----|-------------|------------|-----------|
| Type   | No. |               |    | Number of Holes | Hole Pitch |     |      |    |    |      |      |      |      |    |    |             | GDYC·GDRC  | GDYS·GDRS |
| Side Mount<br>GDYC (Steel)<br>GDYS (Stainless Steel) | 35  | 2000          | 10 | 200             |            | 4.6 | 4.3  | 30 | 25 | 5.3  | 9.9  | 7.9  | 9.3  | -  | 47 | 2.37        |            |           |
|  | 40  |               |    |                 |            | 5.1 | 7.4  |    |    | 8.4  | 13.2 | 11.7 | 13.7 |    |    | 2.31        |            |           |
|  | 50  |               |    |                 |            | 6.4 | 8.9  | 30 | 25 | 10.7 | 16.5 | 14.5 | 16.2 | 53 | -  | 2.24        |            |           |
|  | 60  |               |    |                 |            | 7.4 | 11.7 |    |    | 12.4 | 19.8 | 18.5 | 20.6 |    |    | 2.18        |            |           |
| Up Mount<br>GDRC (Steel)<br>GDRS (Stainless Steel)   | 35  | 2000          | 10 | 200             |            | 4.6 | 4.3  | 30 | 25 | 5.3  | 9.9  | 7.9  | 9.3  | 53 | -  | 2.40        |            |           |
|  | 40  |               |    |                 |            | 5.1 | 7.4  |    |    | 8.4  | 13.2 | 11.7 | 13.7 |    |    | 2.34        |            |           |
|  | 50  |               |    |                 |            | 6.4 | 8.9  | 30 | 25 | 10.7 | 16.5 | 14.5 | 16.2 | 53 | -  | 2.27        |            |           |
|  | 60  |               |    |                 |            | 7.4 | 11.7 |    |    | 12.4 | 19.8 | 18.5 | 20.6 |    |    | 2.21        |            |           |

⚠ Ultra High-Molecular-Weight Polyethylene may change in dimensions as its stretch rate changes by temperature.

|                  |             |   |      |
|------------------|-------------|---|------|
| Ordering Example | Part Number | - | L    |
|                  | GDYC50      | - | 2000 |

## Steel Chain Guides

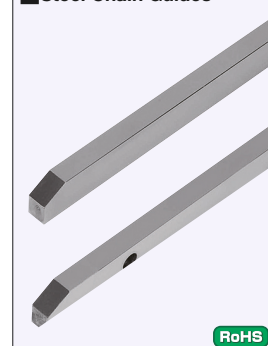

## SGDT

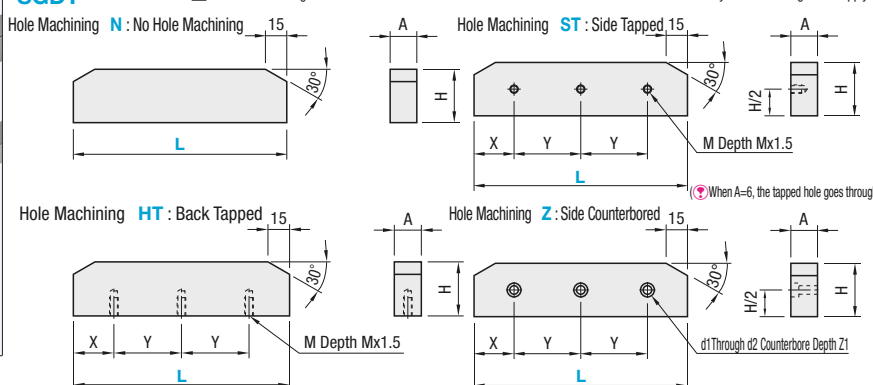

## Mounting Hole

| L    | Number of Holes | X   | Y   |
|------|-----------------|-----|-----|
| 300  | 2               | 100 | 100 |
| 500  | 3               | 150 | 100 |
| 1000 | 5               | 200 | 150 |

Material: EN 1.1191 Equiv. Surface Treatment: Hard Chrome Plating  
⚠ No surface treatment on machined holes.

## L Dimension Selectable Type

| Part Number |     | L Length Selection (mm) |     | A  | H  | d1  | d2  | Z1  | M | L=300 Unit Price |        | L=500 Unit Price |   | L=1000 Unit Price |   |
|-------------|-----|-------------------------|-----|----|----|-----|-----|-----|---|------------------|--------|------------------|---|-------------------|---|
| Type        | No. |                         |     |    |    |     |     |     |   | N                | ST, HT | Z                | N | ST, HT            | Z |
| SGDT        | 40  | 300                     | 500 | 6  | 13 | 4.5 | 8   | 4.5 | 4 |                  |        |                  |   |                   |   |
|             | 50  |                         |     | 9  | 16 | 5.5 | 9.5 | 5.5 | 5 |                  |        |                  |   |                   |   |
|             | 60  |                         |     | 12 | 22 | 6.5 | 11  | 6.5 | 6 |                  |        |                  |   |                   |   |

|                  |             |   |     |
|------------------|-------------|---|-----|
| Ordering Example | Part Number | - | L   |
|                  | SGDT50ST    | - | 500 |

Example When a conveyor or other type chain is operated in highly frictional environments, the roller and palate are worn sharply and thereby, generate dust and noise. This phenomenon causes the service life of the chain to be lowered. As the solution against the said problem, a chain guide with low friction and high abrasion resistance is used. Furthermore, this guide is also used for the purpose of suppressing chain vibration or of controlling the chain travelling path.

