

Extruded Brackets - For 3 Slots

For 5 Series (Slot Width 6mm) Aluminum Extrusions

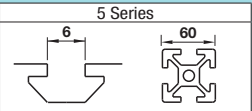

■Features: Extrusions with 3 slots (HFS5-2060, etc.) can be connected with one bracket.

Thick Brackets

NBLTT5
HBLTT5

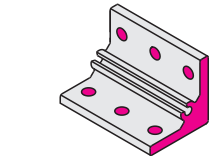
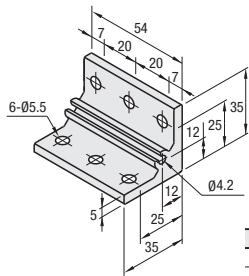

Both sides and screw holes of NBLTT5 is not anodized.

Type	Material	Surface Treatment
NBLTT5	EN AW-6063-T5 Equiv.	Clear Anodize
HBLTT5	EN AC-51400-T5 Equiv.	

Part Number	Mass (g)	Applicable Screw, T Nut				Allowable Load (N)	Unit Price 1~99 pc(s).	Volume Discount Rate 100~200
		Screw	Quantity	T Nut	Quantity			
NBLTT5 HBLTT5	60	CBM5-10	6	HNTT5-5	6	1960		

■Features: Numbers of screws are the same as those of HBLTT5. Extrusions can be connected more securely.

Ultra Thick Brackets

HBLUT5

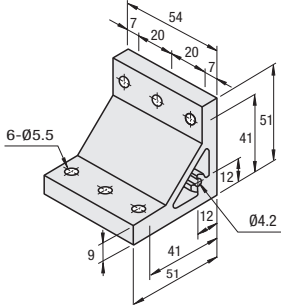

Material: EN AC-51400-T5 Equiv. Surface Treatment: Anodize

Part Number	Mass (g)	Applicable Screw, T Nut				Allowable Load (N)	Unit Price 1~99 pc(s).	Volume Discount Rate 100~200
		Screw	Quantity	T Nut	Quantity			
HBLUT5	119	CBM5-14	6	HNTT5-5	6	1960		

■Features: Brackets for 3-slot extrusions with 6 mounting holes on one side can connect extrusions more securely.

Thick Brackets

HBLTTW5

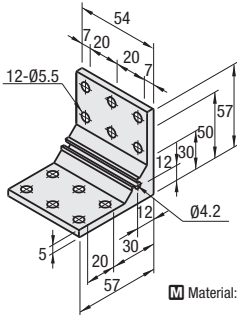
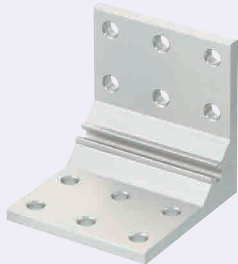

Material: EN AC-51400-T5 Equiv. Surface Treatment: Clear Anodize

Part Number	Mass (g)	Applicable Screw, T Nut				Allowable Load (N)	Unit Price 1~99 pc(s).	Volume Discount Rate 100~200
		Screw	Quantity	T Nut	Quantity			
HBLTTW5	96	CBM5-10	12	HNTT5-5	12	2940		

Ordering Example
Part Number
HBLTT5

Alterations
Part Number
HBLTT5 - (C, SET, SST, SEU, SSU, SEP, SSP, SEC)

Alterations	Code	Spec.	Applicable Bracket
Mounting Hole Alteration for Cover	C	Adds taps on a bracket for cover mounting.	HBLTT5
		(M5 on Both Sides, Depth 15mm)	HBLUT5
		(Mounting Screw HCBM on P.754)	HBLTTW5

Alterations	Code	Spec.	Applicable Bracket
Applicable Screws and Nuts Set	SET	Applicable screws and nuts for fixing the brackets on extrusions come in a set. (Adds to the bracket price.)	NBLTT5
	SST	(Ex.) When HBLTT5 is specified:	
	SEU	(Ex.) When HBLTT5 is specified:	
	SSU	(Ex.) When HBLTT5 is specified:	HBLTT5
	SEP	(Ex.) When HBLTT5 is specified:	
	SSP	(Ex.) When HBLTT5 is specified:	
	SEC	(Ex.) When HBLTT5 is specified:	HBLUT5
	SEP	(Ex.) When HBLTT5 is specified:	
	SSP	(Ex.) When HBLTT5 is specified:	
	SEC	(Ex.) When HBLTT5 is specified:	HBLTTW5
	SEP	(Ex.) When HBLTT5 is specified:	
	SSP	(Ex.) When HBLTT5 is specified:	

Included Screw is not RoHS compliant when -SET, -SEU or -SEP are specified.

Post-Assembly Insertion Easy Brackets

For 5 Series (Slot Width 6mm) Aluminum Extrusions

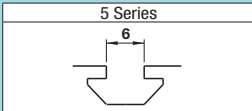

■Features: 2 aluminum extrusions can be easily connected with only 1 tightening screw. Brackets can be mounted on the extrusion slots after assembly.

Post-Assembly Insertion Easy Brackets

Components	Material	Surface Treatment
① Joint Plate	EN 1.0330 Equiv.	Trivalent Chromate
② Joint Brackets	EN 1.1191 Equiv.	
③ Hex Socket Head Cap Screw	EN 1.7220 Equiv.	

HABL5

① Joint Plate

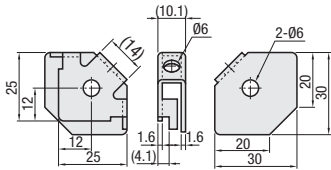

② Joint Brackets

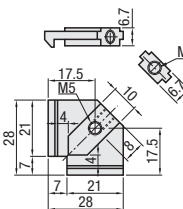

③ Hex Socket Head Cap Screw

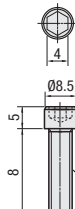

Overtightening may cause deformation of joint plates. (Reference Tightening Torque 5.5N·m)

Part Number	Mass (g)	Included Screw		Allowable Load (N)	Unit Price 1~99 pc(s).	Volume Discount Rate 100~200
		Screw	Quantity			
HABL5	30	Hex Socket Head Cap Screw M5x8	1	250		

Ordering Example
Part Number
HABL5

Connection Method

Step	Front View	Side View	Sketch Drawing
1			
2			
3			
4			

Example

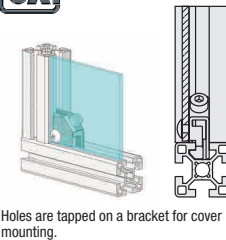

Holes are tapped on a bracket for cover mounting.

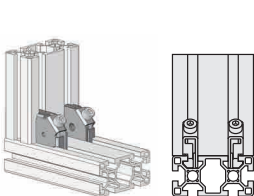

For aluminum extrusions with 2 slots, brackets can be mounted on both sides.

③ Tighten a hex socket head cap screw to fix the plate. (Reference Tightening Torque 5.5N·m)

Overtightening may cause deformation of joint plates.