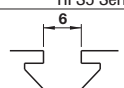

HFS5 Series

-Aluminum Extrusion with Milled Surfaces-

HFS5 Series		Fixing Parts			Others
	6	Brackets	Nuts	Joints	Extrusion End Caps
		P483 P496	P499 P506	P627 P640	P645 P658

CAD Data

■Features: Milled on upper and lower surfaces. Usable for Linear Guides, etc.

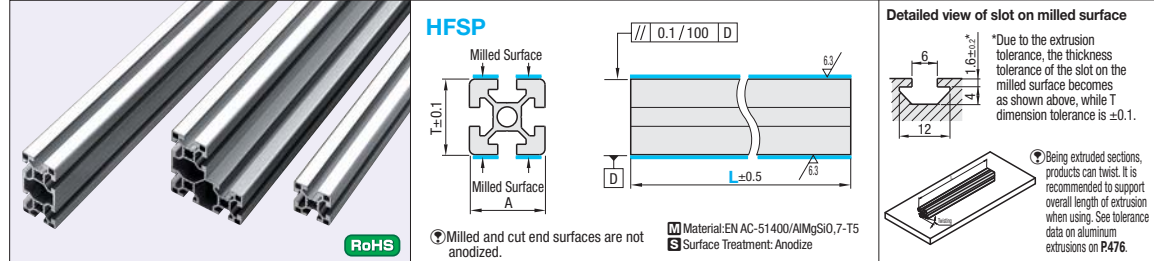

For detailed dimensions and shapes EXCEPT the slots on the milled surface, A and T dimensions, please refer to the drawing of the product of the below Part Number Without "P". (For HFS5 series, refer to P.477) (Ex.) HFSP5-2020 → Fig. HFS5-2020 (P.477)

Square Type
HFSP5-2020
HFSP5-2525
HFSP5-4040

Rectangle Type (Horizontal)
HFSP5-4020
HFSP5-5025
HFSP5-6020
HFSP5-8020
HFSP5-6040
HFSP5-8040

Rectangle Type (Vertical)
HFSP5-2040
HFSP5-2550
HFSP5-2060
HFSP5-2080
HFSP5-4060
HFSP5-4080

L-Shaped Type
HFSP5-404020

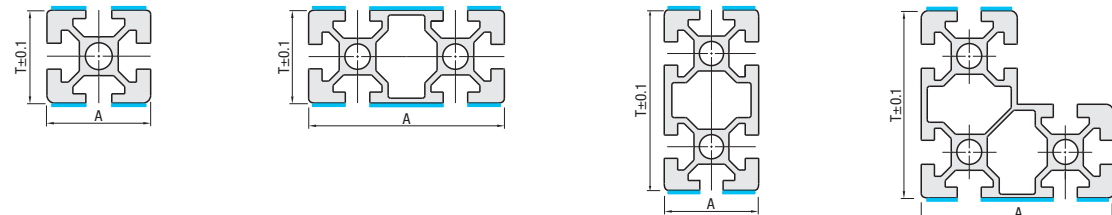

Part Number	L 0.5mm Increment	Extrusions Series	T	A	€ Unit Price Less than 300mm	€ Unit Price/m 300mm or more	Alteration Charge (Body+)	Tapping (Refer to P647)
HFSP5	100~3000	HFS5	19.2	20			Counterboring XA~XE (per row)	Tap Shapes
			19.2	40				Left LTP
			39.2	20				Right RTP
			24.2	25				Both TPW
			24.2	50				
			49.2	25				
			19.2	60				
			59.2	20				
			19.2	80				
			79.2	20				
			39.2	40				
			39.2	60				
			59.2	40				
			39.2	80				
			79.2	40				
			39.2	40				

Order Example: Part Number - L - Days to Ship 8 Days

Price: Volume Discount (Round down to one Cent.) P87

Qty.	1~9 pcs.	10~49	50~
Discount Rate	Less than 300mm	€ Unit Price	5% 10%
	300mm or more	€ Unit Price/m	5% 10%

When L<300mm: € € Unit Price = Price
When L≥300mm: € € Unit Price/m x Specified Full Length = Price
(Ex.) HFSP5-2020-600
25.20 x 0.6m = 15.10 EUR (Round down to ten Cent.)

Alterations: Drilling hole at a specified position can be done. • Nuts for Extrusion Please use nuts for aluminum extrusions. Refer to P499-508

Alterations	Counterboring					Wrench Hole				
Code	Z Selection	XA	XB	XC	XD	XE	D Selection	AV	BV	CV
Spec.	Z	d	d1	Distance from The Left End Plane mm			D	Distance from The Left End Plane mm		
Specifications of Hole Size and Hole Position	5	5.5	9.5	7~L-7			7	7~L-7		
	6	6.5	11							

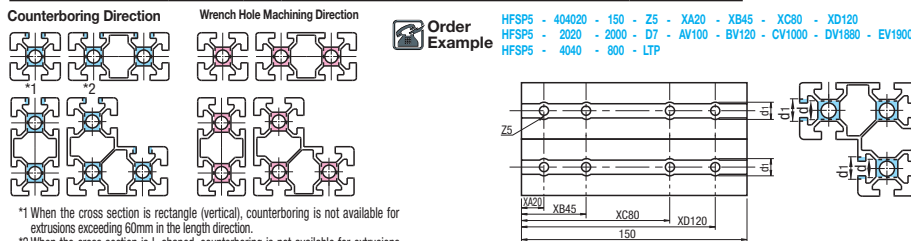

*1 When the cross section is rectangle (vertical), counterboring is not available for extrusions exceeding 60mm in the length direction.
*2 When the cross section is L-shaped, counterboring is not available for extrusions exceeding 60mm in longitudinal direction, except for the lower portion.

HFS5 Series

-Curved Extrusions-

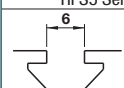
HFS5 Series		Fixing Parts			Others
	20	Brackets	Nuts	Joints	Extrusion End Caps
		P483 P496	P499 P506	P627 P640	P645 P658

CAD Data

■Features: Bending is applied to HFS5-2020. Combination use with Curved Panel is possible. (Refer to P886)

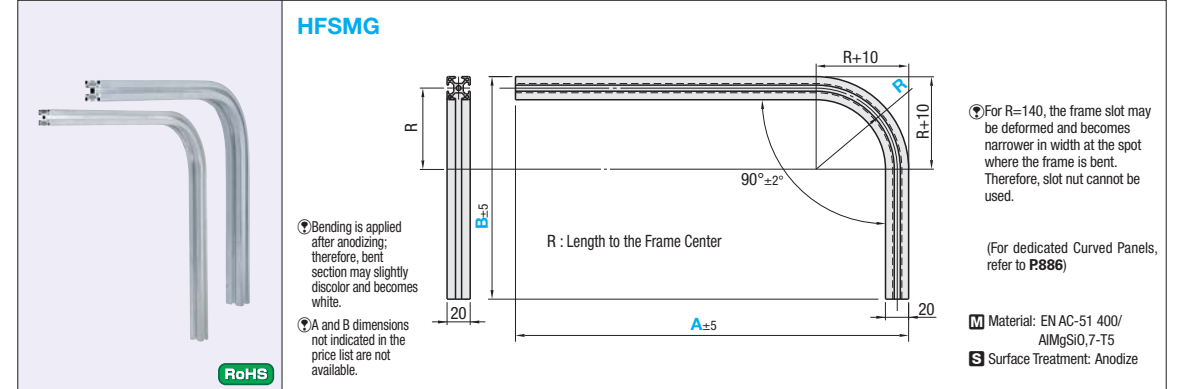

Part Number	A 1mm Increment	B 1mm Increment	R *	Series	Mass kg/m	Sectional Area mm²	Cross Sectional Moment of Inertia mm⁴	
Type	No.						lx	ly
HFSMG	5-2020	200~1500	200~1000	140 300* 500*	HFS5	0.50	183	0.742x10⁴

* Curved panels for R300 and R500 are not available.

Order Example: Part Number - A - B - R - Days to Ship 10 Days

Price: Volume Discount (Round down to one Cent.) P87

Qty.	1~9	10~49	50~
Discount Rate	€ Unit Price	5%	10%

Part Number	A	€ Unit Price											
Type	No.	R140				R300				R500			
		B				B				B			
		200~300	301~400	401~500	501~600	601~700	701~800	801~900	901~1000	400~500	501~600	601~700	701~800
HFSMG	5-2020	200~300											
		301~400											
		401~500											
		501~600											
		601~700											
		701~800											
		801~900											
		901~1000											

Alterations: Part Number - A - B - R - (LTP · RTP · TPW...etc.) - Days to Ship 10 Days

Alterations	Tap (Refer to P647)			M Hole (Refer to P656)			
Code	LTP	RTP	TPW	LMH	LMV	RMH	RMV
Spec.	Tapping to the center hole Tap Shape M5 Depth 15 LTP: Tapping on the Left End Face RTP: Tapping on the Bottom End Face TPW: Tapping on the Both Ends			Adds M type hole in specified position. LMH, RMH: Machines M type hole on the left-hand bottom of the extrusion from the horizontal direction. Ex. LMH LMV, RMV: Machines a hole on the left-hand bottom of the extrusion from the vertical (right) direction. Ex. RMV			
Applicable Extrusions	HFSMG5-2020			2,70 5,40 1,20			

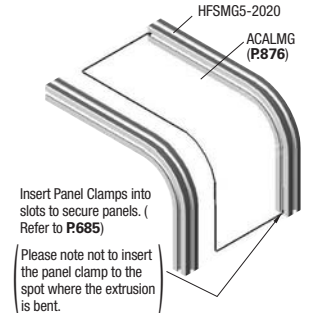

*When tapping and M type hole alteration are both specified, the depth of tapping hole will be up to M Hole.