

Part Number	Type	No.	Open/Close Direction	Panel (Select a desired material and thickness from the codes below)	W (Width) 1mm increments	H (Height) 1mm increments	L1	L2	Components														
									Frame*	Fixing Parts	Panel Clamps	Sliders for Folding Doors	Handle	Hinges (for middle)	Hinges (for fixing)	Extrusion End Caps							
HHUA	6	L (Left)	R (Right)	AC AC3 (Thickness 5mm 3mm)	500-1500	500-1000	L2+28	W/2-15	HFS6-3030	HCJ6	8	HSCP3H-B (Thickness 3mm)	8	HFAFSH6	2	HHD20-SST	2	HHP5N6-SST	2	HHPFLN6-SST	2	HFC6-3030-S	8
				PC PC3 (Thickness 5mm 3mm)			W/2-15	L1+28	HSCP3H-B (Thickness 3mm)	HSCP3H-B	HFAFSH6	HHD20-SST	HHP5N6-SST	HHPFLN6-SST	HFC6-3030-S								
	PY PY3 (Thickness 5mm 3mm)	L2+46	W/2-24	HFS8-4040	HCJ8	8	HSCP7H-B (Thickness 5mm 3mm)	8	HFAFSH8	2	HHD26-SST	2	HHP5N8-SST	2	HHPFLN8-SST	2	HFC8-4040-S	8					
	ST ST3 (Thickness 5mm 3mm)	W/2-24	L1+46	HSCP7H-B	HFAFSH8	HHD26-SST	HHP5N8-SST	HHPFLN8-SST	HFC8-4040-S														
8	L (Left)	R (Right)	Anti-static PVC (Clear)	500-1500	500-1000	L2+46	W/2-24	HFS8-4040	HCJ8	8	HSCP7H-B (Thickness 5mm 3mm)	8	HFAFSH8	2	HHD26-SST	2	HHP5N8-SST	2	HHPFLN8-SST	2	HFC8-4040-S	8	
			ST ST3 (Thickness 5mm 3mm)			W/2-24	L1+46	HSCP7H-B	HFAFSH8	HHD26-SST	HHP5N8-SST	HHPFLN8-SST	HFC8-4040-S										
8	L (Left)	R (Right)	No panel	500-1500	500-1000	L2+46	W/2-24	HFS8-4040	HCJ8	8	HSCP7H-B (Thickness 5mm 3mm)	8	HFAFSH8	2	HHD26-SST	2	HHP5N8-SST	2	HHPFLN8-SST	2	HFC8-4040-S	8	
			NN			W/2-24	L1+46	HSCP7H-B	HFAFSH8	HHD26-SST	HHP5N8-SST	HHPFLN8-SST	HFC8-4040-S										

**Order Example** Part Number - Panel - W - H  
 HHUA6L - PC - 1000 - 800

**Days to Ship** 10 Days

**Price** The price of this product is the price shown in the table multiplied by each material rate. (Round down to ten Cent.)  
 (Example) For HHUA6L-PY-800-900: 292,00 EURx0.9=262,80 EUR

Panel	Material Rate
Thickness 5mm	
AC Acrylic (Clear)	x1.0
PC Polycarbonate (Clear)	x1.2
PY PET (Clear)	x0.9
ST Anti-static PVC (Clear)	x1.3
Thickness 3mm	
AC3 Acrylic (Clear)	x0.9
PC3 Polycarbonate (Clear)	x1.0
PY3 PET (Clear)	x0.9
ST3 Anti-static PVC (Clear)	x1.1
No panel	x0.6

Part Number	W (mm)	€ H/Height
HHUA	500-749	
	750-999	
	1000-1249	
	1250-1500	
	500-749	
	750-999	
1000-1249		
1250-1500		

**Example** Example of folding door assembly (For left opening door)

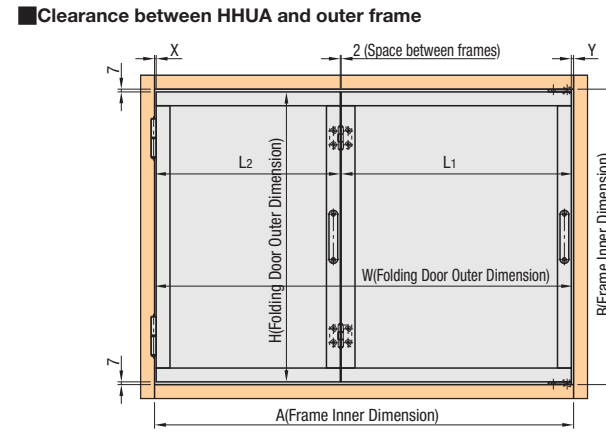
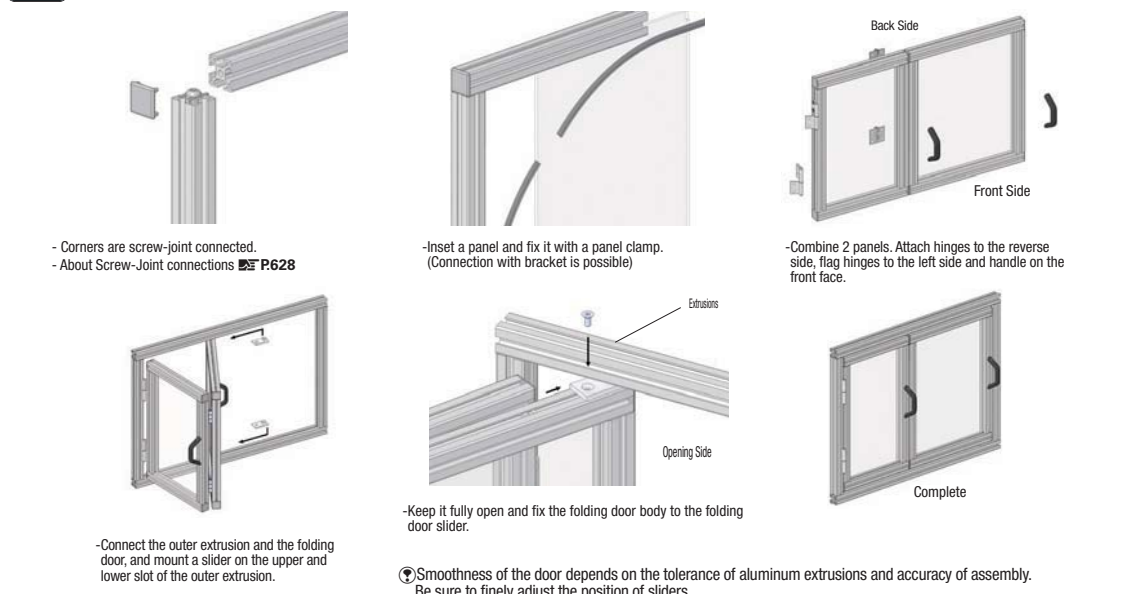

**Details of Each Component**

Part Number	Product Name	Page
HFS6-3030	30 SQ. Alum. Extrusions	P511
HFS8-4040	40 SQ. Alum. Extrusions	P553
HCJ	Screw Joints	P628
HSCP3H-B, HSCP5H-B	Panel Clamps	P685
HFAFSH	Sliders for Folding Doors	P764
HHDF	Handle	P741
HHP5N	Hinges	P719
HHPFLN (HHPFRN)	Aluminum Flag Hinges	P726
HFC6-3030-S, HFC8-4040-S	Extrusion End Caps	P551



Folding Door Units	Type	No.	Outer Frame											
			W Dimension	H Dimension	X Dimension	Y Dimension	W Dimension	H Dimension	X Dimension	Y Dimension				
HHUA	6	8	A-Y-X	B-14	3.5	7.5	6.5	5.5	A-Y-X	B-14	4.5	11.5	9.5	7.5
			30 Square (HFS6)	40 Square (HFS8)										

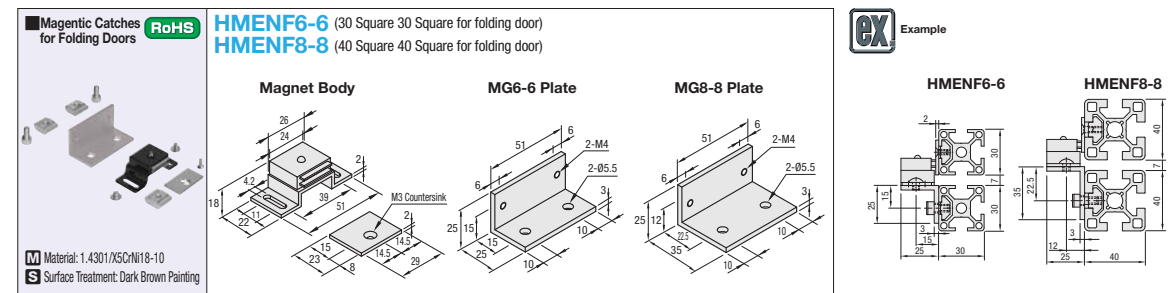

Part Number	Type	Applicable Extrusion	Magnet	Components						€ Unit Price	Volume Discount				
				Retaining Force N(kgf)	Mounting Plate	For Magnet Fitting			Door Side (Extrusion Side) For Extrusion Mounting						
HMENF	6-6	30 Square	29.4	MG6-6	Truss Screw M4-5	2	SCB5-10	2	HNTT6-5	2	M3-8	1	HNTT6-3	1	
	8-8	40 Square	(3)	MG8-8	Truss Screw M4-5	2	SCB5-12	2	HNTT8-5	2	M3-8	1	HNTT8-3	1	

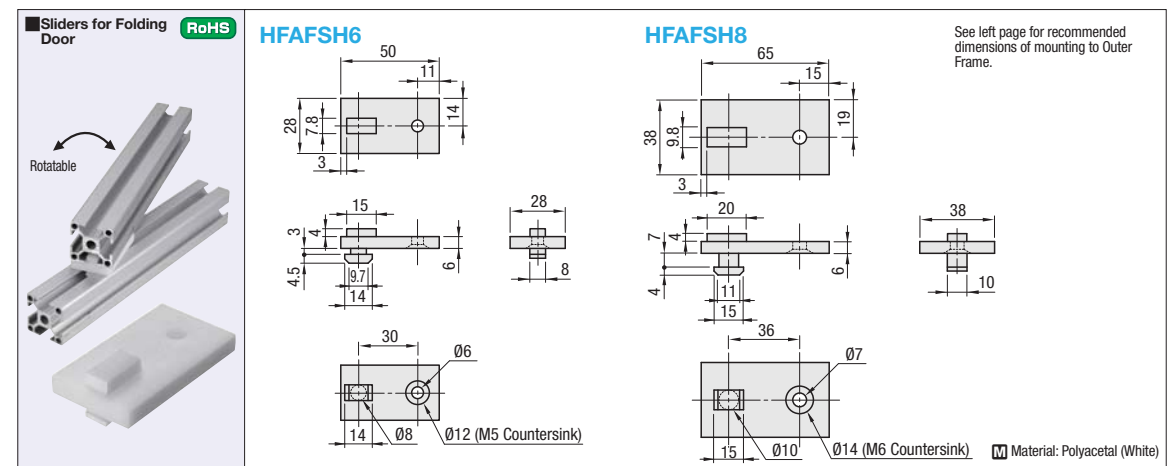

Part Number	Type	No.	Applicable Extrusions (Series)		Included Screws and Nuts			€ Unit Price	Volume Discount
			Folding door side extrusion	Outer frame	Screws	Nuts	Quantity		
HFAFSH	6	8	HFS6	HFS6	SHFBS5-12	1	SHNTP6-5	1	
	HFS8*	HFS8*	SHFBS6-15	1	SHNTP8-6	1			

\* Cannot be used for HFS8-45, HFS8-50, HFS8-60

**Order Example** Part Number HFAFSH6

**Days to Ship** 6 Days