

DIN 931 similar to ISO 4014

Hexagon head bolts

Hexagon head | external hex | with body

Steel 8.8 | zinc-plated | Cr(VI)-free | Metric thread

Further information: DIN-standard has been withdrawn | changed spanner widths for M10, M12, M14 and M22 | screws can be paired with a 6h tolerance-compliant female thread

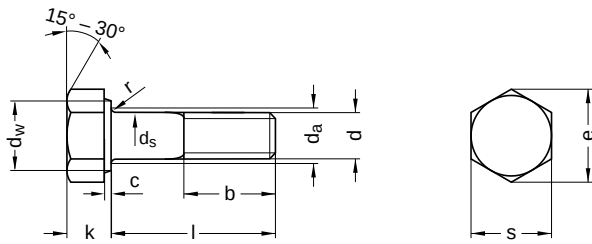

Diameter (d)	b			c		d _a max.	d _s max.
	longer than 200	l up to 125	l up to 200	min.	max.		
M 4	20	14	20	0.15	0.4	4.7	4
M 5	35	16	22	0.15	0.5	5.7	5
M 6	37	18	24	0.15	0.5	6.8	6
M 8	41	22	28	0.15	0.6	9.2	8
M 10	45	26	32	0.15	0.6	11.2	10
M 12	49	30	36	0.15	0.6	13.7	12
M 14	53	34	40	0.15	0.6	15.7	14
M 16	57	38	44	0.20	0.8	17.7	16
M 18	61	42	48	0.20	0.8	20.2	18
M 20	65	46	52	0.20	0.8	22.4	20
M 24	73	54	60	0.20	0.8	26.4	24
M 27	79	60	66	0.20	0.8	30.4	27
M 30	85	66	72	0.20	0.8	33.4	30
M 33	91	72	78	0.20	0.8	36.4	33
M 36	97	78	84	0.20	0.8	39.4	36

Diameter (d)	d _w	e min.	k		r min.	s		Pitch (P)
	min.		min.	max.		max.	min.	
M 4	5.9	7.66	2.68	2.92	0.20	7	6.78	0.70
M 5	6.9	8.79	3.35	3.65	0.20	8	7.79	0.80
M 6	8.9	11.05	3.85	4.15	0.25	10	9.78	1.00
M 8	11.6	14.38	5.15	5.45	0.40	13	12.73	1.25
M 10	15.6	18.90	6.22	6.58	0.40	17	16.73	1.50
M 12	17.4	21.10	7.32	7.68	0.60	19	18.67	1.75
M 14	20.5	24.49	8.62	8.98	0.60	22	21.67	2.00
M 16	22.0	26.17	9.71	10.29	0.60	27	26.16	2.00
M 18	24.8	29.56	11.15	11.85	0.60	27	26.16	2.50
M 20	27.7	32.95	12.15	12.85	0.80	30	29.16	2.50
M 24	33.2	39.55	14.65	15.35	0.80	36	15.39	3.00
M 27	38.0	45.20	16.65	17.35	1.00	41	40.00	3.00

All technical data refer to the measure mm



DIN 931 similar to ISO 4014

Hexagon head bolts

Hexagon head | external hex | with body

Steel 8.8 | zinc-plated | Cr(VI)-free | Metric thread

Diameter (d)	d _w	e	k		r	s		Pitch (P)
	min.	min.	min.	max.	min.	max.	min.	
M 30	42.7	50.85	18.28	19.12	1.00	46	45.00	3.50
M 33	46.6	55.37	20.58	21.42	1.00	50	49.00	3.50
M 36	51.1	60.79	22.08	22.92	1.00	55	53.80	4.00

nominal size	Length (l)	
	min.	max.
25	24.58	25.42
30	29.58	30.42
35	34.50	35.50
40	39.50	40.50
45	44.50	45.50
50	49.50	50.50
55	54.40	55.60
60	59.40	60.60
65	64.40	65.60
70	69.40	70.60
75	74.40	75.60
80	79.40	80.60
85	83.25	86.75
90	88.25	91.75
95	93.25	96.75
100	98.25	100.75

nominal size	Length (l)	
	min.	max.
110	108.25	111.75
115	113.25	116.75
120	118.25	121.75
125	123.00	127.00
130	128.00	132.00
140	138.00	142.00
145	143.00	147.00
150	148.00	152.00
160	158.00	162.00
170	168.00	172.00
180	178.00	182.00
190	187.70	192.30
200	197.70	202.30
210	207.70	212.30
220	217.70	222.30
230	227.70	232.30

nominal size	Length (l)	
	min.	max.
240	237.70	242.30
250	247.70	252.30
260	257.40	262.60
270	267.40	272.60
280	277.40	282.60
290	287.40	292.60
300	297.40	302.60
320	317.15	322.85
340	337.15	342.85
360	357.15	362.85
380	377.15	382.85
400	397.15	402.85

All technical data refer to the measure mm

