

DIN 934 similar to ISO 4032

Hexagon nuts

External hex

Steel 5 - 2 | bright | Cr(VI)-free | Metric thread

Further information: DIN-standard has been withdrawn | changed spanner widths for M10, M12, M14 and M22 | the fine thread has been transferred to ISO 8673

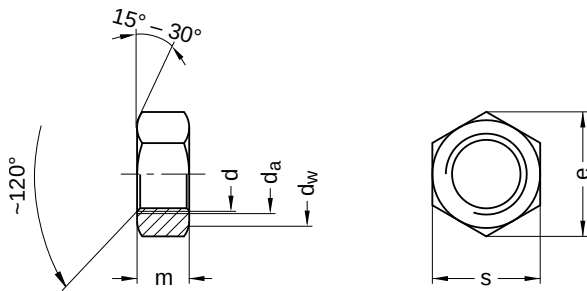

Diameter (d)	d _a		d _w	e	m		s		Pitch (P)
	min.	max.			min.	max.	min.	max.	
M 6	6	6.75	8.8	11.05	4.70	5.0	9.78	10	1.00
M 8	8	8.75	11.3	14.38	6.14	6.5	12.73	13	1.25
M 10	10	10.80	15.3	18.90	7.64	8.0	16.73	17	1.50
M 12	12	13.00	17.2	21.10	9.64	10.0	18.67	19	1.75
M 14	14	15.10	20.2	24.49	10.30	11.0	21.67	22	2.00
M 16	16	17.30	22.2	26.75	12.30	13.0	23.67	24	2.00
M 18	18	19.50	25.3	29.56	14.30	15.0	26.16	27	2.50
M 20	20	21.60	28.2	32.95	14.90	16.0	29.16	30	2.50
M 22	22	23.70	29.5	35.03	16.90	18.0	31.00	32	2.50
M 24	24	25.90	33.2	39.55	17.70	19.0	35.00	36	3.00
M 27	27	29.10	38.0	45.20	20.70	22.0	40.00	41	3.00
M 30	30	32.40	42.7	50.65	22.70	24.0	45.00	46	3.50
M 33	33	35.60	46.6	55.37	24.70	26.0	49.00	50	3.50
M 36	36	38.90	51.1	60.79	27.40	29.0	53.80	55	4.00
M 39	39	42.10	55.9	66.44	29.40	31.0	58.80	60	4.00
M 42	42	45.40	60.6	71.30	32.40	34.0	63.10	65	4.50
M 45	45	48.60	64.7	76.95	34.40	36.0	68.10	70	4.50

All technical data refer to the measure mm

