



FAG

★ 16013

Deep groove ball bearing

Schaeffler ID:
0167011430000Deep groove ball bearing 160, single row,
steel sheet metal cage

★ Preferred product

Technical information

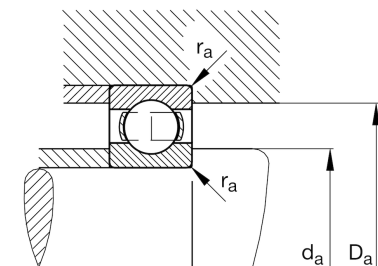
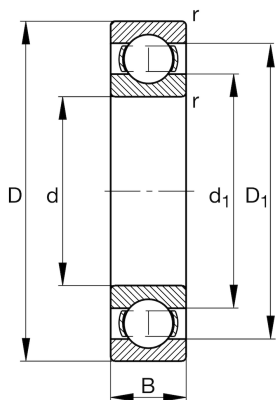

Temperature range

T_{\min}	-30 °C	Operating temperature min.
T_{\max}	150 °C	Operating temperature max.
	0,294 kg	Weight

Main Dimensions & Performance Data

d	65 mm	Bore diameter
D	100 mm	Outside diameter
B	11 mm	Width
C_r	22.500 N	Basic dynamic load rating, radial
C_{0r}	19.700 N	Basic static load rating, radial
C_{ur}	940 N	Fatigue load limit, radial
n_G	9.900 1/min	Limiting speed
n_{gr}	5.300 1/min	Reference speed

Dimensions

r_{\min}	0,6 mm	Minimum chamfer dimension
D_1	88 mm	Shoulder diameter outer ring
d_1	77,1 mm	Shoulder diameter inner ring

Mounting dimensions

$d_{a\min}$	68,2 mm	Minimum diameter shaft shoulder
$D_{a\max}$	96,8 mm	Maximum diameter of housing shoulder
$r_{a\max}$	0,6 mm	Maximum fillet radius

Calculation factors

f_0	16,5	Calculation factor
-------	------	--------------------