



FAG

16044-M

Deep groove ball bearing

Schaeffler ID:
0190117760000Deep groove ball bearing 160..-M, single
row, solid brass cage

Technical information

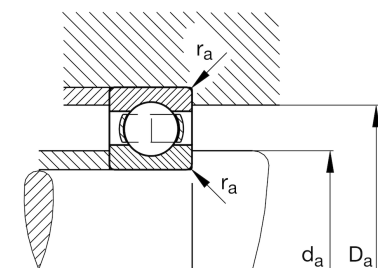
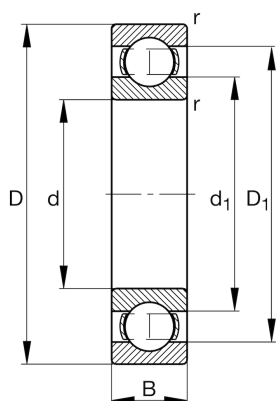
**Temperature range**

T_{min}	-30 °C	Operating temperature min.
T_{max}	200 °C	Operating temperature max.
	13,3 kg	Weight

Main Dimensions & Performance Data

d	220 mm	Bore diameter
D	340 mm	Outside diameter
B	37 mm	Width
C_r	198.000 N	Basic dynamic load rating, radial
C_{0r}	240.000 N	Basic static load rating, radial
C_{ur}	8.600 N	Fatigue load limit, radial
n_G	3.400 1/min	Limiting speed
n_{gr}	2.310 1/min	Reference speed

Dimensions

r_{min}	2,1 mm	Minimum chamfer dimension
D_1	298,1 mm	Shoulder diameter outer ring
d_1	262,8 mm	Shoulder diameter inner ring

Mounting dimensions

$d_{a min}$	230,2 mm	Minimum diameter shaft shoulder
$D_{a max}$	329,8 mm	Maximum diameter of housing shoulder
$r_{a max}$	2,1 mm	Maximum fillet radius

Calculation factors

f_0	16,3	Calculation factor
-------	------	--------------------