



FAG

16048-MA

Deep groove ball bearing

Schaeffler ID:
0190118140000Deep groove ball bearing 160..-MA, single
row, solid brass cage

Technical information

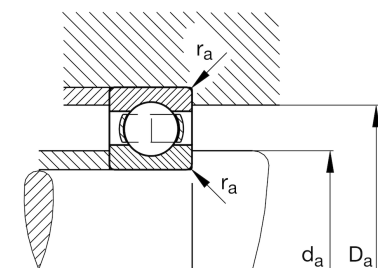
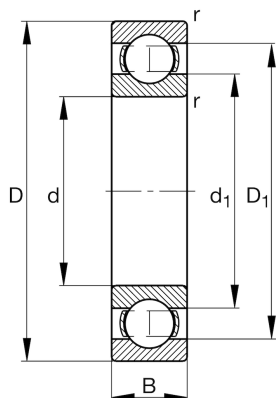
**Temperature range**

T_{\min}	-30 °C	Operating temperature min.
T_{\max}	200 °C	Operating temperature max.
	14,321 kg	Weight

Main Dimensions & Performance Data

d	240 mm	Bore diameter
D	360 mm	Outside diameter
B	37 mm	Width
C_r	203.000 N	Basic dynamic load rating, radial
C_{0r}	255.000 N	Basic static load rating, radial
C_{ur}	8.700 N	Fatigue load limit, radial
n_G	3.200 1/min	Limiting speed
n_{gr}	2.100 1/min	Reference speed

Dimensions

r_{\min}	2,1 mm	Minimum chamfer dimension
D_1	318,4 mm	Shoulder diameter outer ring
d_1	283,1 mm	Shoulder diameter inner ring

Mounting dimensions

$d_{a \min}$	250,2 mm	Minimum diameter shaft shoulder
$D_{a \max}$	349,8 mm	Maximum diameter of housing shoulder
$r_{a \max}$	2,1 mm	Maximum fillet radius

Calculation factors

f_0	16,4	Calculation factor
-------	------	--------------------