



FAG

★ 16052

Deep groove ball bearing

Schaeffler ID:
0190118300000Deep groove ball bearing 160, single row,
steel sheet metal cage

★ Preferred product

Technical information

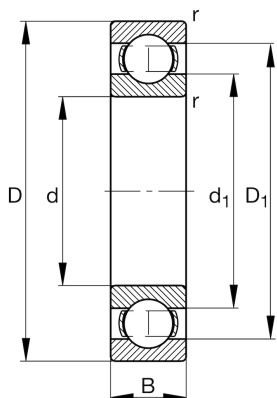

Temperature range

T_{\min}	-30 °C	Operating temperature min.
T_{\max}	200 °C	Operating temperature max.
	19,1 kg	Weight

Main Dimensions & Performance Data

d	260 mm	Bore diameter
D	400 mm	Outside diameter
B	44 mm	Width
C_r	237.000 N	Basic dynamic load rating, radial
C_{0r}	310.000 N	Basic static load rating, radial
C_{ur}	10.200 N	Fatigue load limit, radial
n_G	2.190 1/min	Limiting speed
n_{gr}	1.960 1/min	Reference speed

Dimensions

r_{\min}	3 mm	Minimum chamfer dimension
D_1	351,2 mm	Shoulder diameter outer ring
d_1	310 mm	Shoulder diameter inner ring

Mounting dimensions

$d_{a\min}$	272,4 mm	Minimum diameter shaft shoulder
$D_{a\max}$	387,6 mm	Maximum diameter of housing shoulder
$r_{a\max}$	2,5 mm	Maximum fillet radius

Calculation factors

f_0	16,4	Calculation factor
-------	------	--------------------