

FAG

## ★ 4206-BB-TVH

Deep groove ball bearing

Schaeffler ID:  
021943460000Deep groove ball bearing 42...BB-TVH,  
double row, plastic cage

★ Preferred product

## Technical information

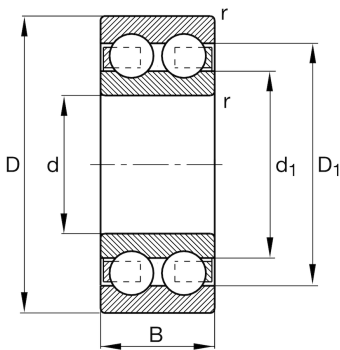

## Temperature range

$T_{min}$	-20 °C	Operating temperature min.
$T_{max}$	120 °C	Operating temperature max.
	0,248 kg	Weight

## Main Dimensions &amp; Performance Data

d	30 mm	Bore diameter
D	62 mm	Outside diameter
B	20 mm	Width
$C_r$	29.000 N	Basic dynamic load rating, radial
$C_{0r}$	21.600 N	Basic static load rating, radial
$C_{ur}$	1.130 N	Fatigue load limit, radial
$n_G$	9.400 1/min	Limiting speed
$n_{gr}$	9.600 1/min	Reference speed

## Dimensions

$r_{min}$	1 mm	Minimum chamfer dimension
$D_1$	51,8 mm	Shoulder diameter outer ring
$d_1$	39,9 mm	Shoulder diameter inner ring

## Mounting dimensions

$d_{a min}$	35,6 mm	Minimum diameter shaft shoulder
$D_{a max}$	56,4 mm	Maximum diameter of housing shoulder
$r_{a max}$	1 mm	Maximum fillet radius

## Calculation factors

$f_0$	14,2	Calculation factor
-------	------	--------------------

