**FAG**★ **4213-B-TVH**

Deep groove ball bearing

Schaeffler ID:
0167144230000Deep groove ball bearing 42...-B-TVH,
double row, plastic cage

★ Preferred product

Technical information

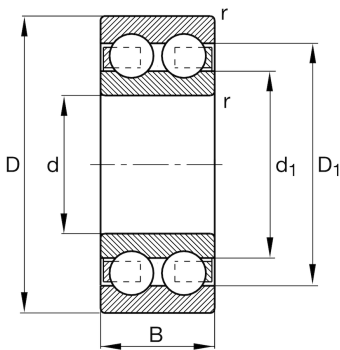

Temperature range

T_{\min}	-20 °C	Operating temperature min.
T_{\max}	120 °C	Operating temperature max.
	1,44 kg	Weight

Main Dimensions & Performance Data

d	65 mm	Bore diameter
D	120 mm	Outside diameter
B	31 mm	Width
C_r	67.000 N	Basic dynamic load rating, radial
C_{0r}	67.000 N	Basic static load rating, radial
C_{ur}	3.450 N	Fatigue load limit, radial
n_G	4.650 1/min	Limiting speed
n_{gr}	5.400 1/min	Reference speed

Dimensions

r_{\min}	1,5 mm	Minimum chamfer dimension
D_1	101,9 mm	Shoulder diameter outer ring
d_1	84,2 mm	Shoulder diameter inner ring

Mounting dimensions

$d_{a\min}$	74 mm	Minimum diameter shaft shoulder
$D_{a\max}$	111 mm	Maximum diameter of housing shoulder
$r_{a\max}$	1,5 mm	Maximum fillet radius

Calculation factors

f_0	15,3	Calculation factor
-------	------	--------------------

