

FAG

## ★ 4302-BB-TVH

Deep groove ball bearing

Schaeffler ID:  
0209379890000Deep groove ball bearing 43...BB-TVH,  
double row, plastic cage

★ Preferred product

## Technical information

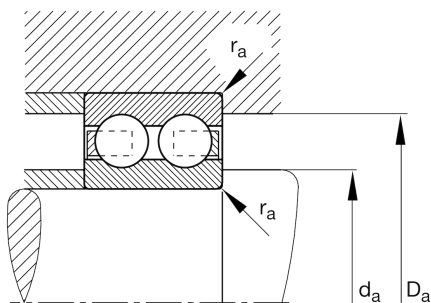
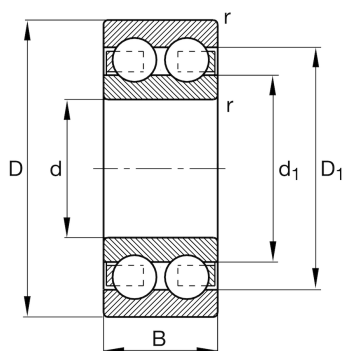

## Temperature range

$T_{\min}$	-20 °C	Operating temperature min.
$T_{\max}$	120 °C	Operating temperature max.
	0,118 kg	Weight

## Main Dimensions &amp; Performance Data

d	15 mm	Bore diameter
D	42 mm	Outside diameter
B	17 mm	Width
$C_r$	15.600 N	Basic dynamic load rating, radial
$C_{0r}$	9.500 N	Basic static load rating, radial
$C_{ur}$	495 N	Fatigue load limit, radial
$n_G$	14.900 1/min	Limiting speed
$n_{gr}$	11.600 1/min	Reference speed

## Dimensions

$r_{\min}$	0,6 mm	Minimum chamfer dimension
$D_1$	32,9 mm	Shoulder diameter outer ring
$d_1$	23,8 mm	Shoulder diameter inner ring

## Mounting dimensions

$d_{a\min}$	20,6 mm	Minimum diameter shaft shoulder
$D_{a\max}$	36,4 mm	Maximum diameter of housing shoulder
$r_{a\max}$	0,6 mm	Maximum fillet radius

## Calculation factors

$f_0$	13	Calculation factor
-------	----	--------------------