

**FAG**★ **6026**

Deep groove ball bearing

Schaeffler ID:  
0167185500000Deep groove ball bearing 60, single row,  
steel sheet metal cage

★ Preferred product

## Technical information

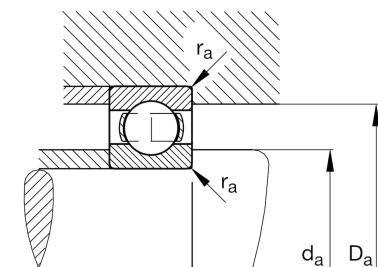
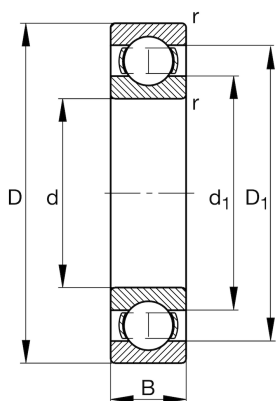

## Temperature range

|            |         |                            |
|------------|---------|----------------------------|
| $T_{\min}$ | -30 °C  | Operating temperature min. |
| $T_{\max}$ | 150 °C  | Operating temperature max. |
|            | 3,42 kg | Weight                     |

## Main Dimensions &amp; Performance Data

|          |             |                                   |
|----------|-------------|-----------------------------------|
| d        | 130 mm      | Bore diameter                     |
| D        | 200 mm      | Outside diameter                  |
| B        | 33 mm       | Width                             |
| $C_r$    | 113.000 N   | Basic dynamic load rating, radial |
| $C_{0r}$ | 101.000 N   | Basic static load rating, radial  |
| $C_{ur}$ | 5.000 N     | Fatigue load limit, radial        |
| $n_G$    | 4.500 1/min | Limiting speed                    |
| $n_{gr}$ | 4.350 1/min | Reference speed                   |

## Dimensions

|            |          |                              |
|------------|----------|------------------------------|
| $r_{\min}$ | 2 mm     | Minimum chamfer dimension    |
| $D_1$      | 177,9 mm | Shoulder diameter outer ring |
| $d_1$      | 153,3 mm | Shoulder diameter inner ring |

## Mounting dimensions

|             |          |                                      |
|-------------|----------|--------------------------------------|
| $d_{a\min}$ | 138,8 mm | Minimum diameter shaft shoulder      |
| $D_{a\max}$ | 191,2 mm | Maximum diameter of housing shoulder |
| $r_{a\max}$ | 2 mm     | Maximum fillet radius                |

## Calculation factors

|       |      |                    |
|-------|------|--------------------|
| $f_0$ | 15,8 | Calculation factor |
|-------|------|--------------------|