

FAG

★ 6030

Deep groove ball bearing

Schaeffler ID:
0167186580000Deep groove ball bearing 60, single row,
steel sheet metal cage

★ Preferred product

Technical information

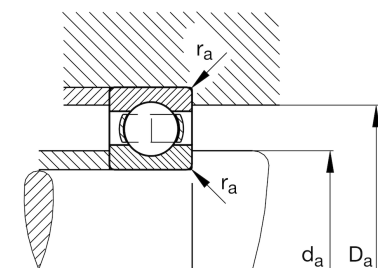
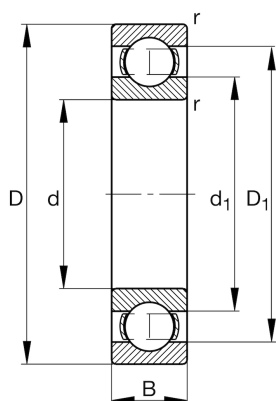

Temperature range

T_{\min}	-30 °C	Operating temperature min.
T_{\max}	150 °C	Operating temperature max.
	4,12 kg	Weight

Main Dimensions & Performance Data

d	150 mm	Bore diameter
D	225 mm	Outside diameter
B	35 mm	Width
C_r	131.000 N	Basic dynamic load rating, radial
C_{0r}	124.000 N	Basic static load rating, radial
C_{ur}	5.600 N	Fatigue load limit, radial
n_G	3.950 1/min	Limiting speed
n_{gr}	3.850 1/min	Reference speed

Dimensions

r_{\min}	2,1 mm	Minimum chamfer dimension
D_1	201,4 mm	Shoulder diameter outer ring
d_1	174,4 mm	Shoulder diameter inner ring

Mounting dimensions

$d_{a\min}$	160,2 mm	Minimum diameter shaft shoulder
$D_{a\max}$	214,8 mm	Maximum diameter of housing shoulder
$r_{a\max}$	2,1 mm	Maximum fillet radius

Calculation factors

f_0	16	Calculation factor
-------	----	--------------------