

FAG

★ 6034-M

Deep groove ball bearing

Schaeffler ID:
0167187120000Deep groove ball bearing 60...-M, single
row, solid brass cage

★ Preferred product

Technical information

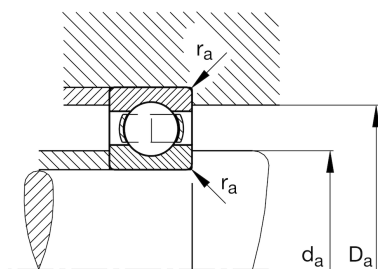
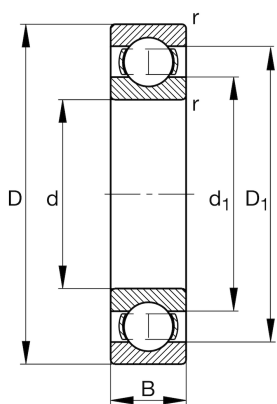

Temperature range

T_{\min}	-30 °C	Operating temperature min.
T_{\max}	200 °C	Operating temperature max.
	8,187 kg	Weight

Main Dimensions & Performance Data

d	170 mm	Bore diameter
D	260 mm	Outside diameter
B	42 mm	Width
C_r	179.000 N	Basic dynamic load rating, radial
C_{0r}	172.000 N	Basic static load rating, radial
C_{ur}	7.600 N	Fatigue load limit, radial
n_G	4.400 1/min	Limiting speed
n_{gr}	3.550 1/min	Reference speed

Dimensions

r_{\min}	2,1 mm	Minimum chamfer dimension
D_1	231,2 mm	Shoulder diameter outer ring
d_1	199,4 mm	Shoulder diameter inner ring

Mounting dimensions

$d_{a\min}$	180,2 mm	Minimum diameter shaft shoulder
$D_{a\max}$	249,8 mm	Maximum diameter of housing shoulder
$r_{a\max}$	2,1 mm	Maximum fillet radius

Calculation factors

f_0	15,7	Calculation factor
-------	------	--------------------