

FAG

## ★ 6048-M

Deep groove ball bearing

Schaeffler ID:  
0167187710000Deep groove ball bearing 60..-M, single  
row, solid brass cage

★ Preferred product

## Technical information

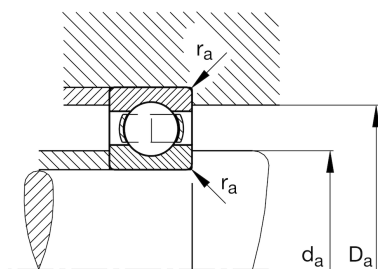
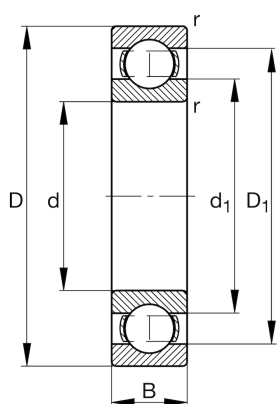

## Temperature range

$T_{\min}$	-30 °C	Operating temperature min.
$T_{\max}$	200 °C	Operating temperature max.
	20,5 kg	Weight

## Main Dimensions &amp; Performance Data

d	240 mm	Bore diameter
D	360 mm	Outside diameter
B	56 mm	Width
$C_r$	255.000 N	Basic dynamic load rating, radial
$C_{0r}$	315.000 N	Basic static load rating, radial
$C_{ur}$	11.700 N	Fatigue load limit, radial
$n_G$	3.100 1/min	Limiting speed
$n_{gr}$	2.450 1/min	Reference speed

## Dimensions

$r_{\min}$	3 mm	Minimum chamfer dimension
$D_1$	321,9 mm	Shoulder diameter outer ring
$d_1$	278,8 mm	Shoulder diameter inner ring

## Mounting dimensions

$d_{a\min}$	252,4 mm	Minimum diameter shaft shoulder
$D_{a\max}$	347,6 mm	Maximum diameter of housing shoulder
$r_{a\max}$	2,5 mm	Maximum fillet radius

## Calculation factors

$f_0$	15,8	Calculation factor
-------	------	--------------------