

FAG

## ★ 607

## Deep groove ball bearing

Schaeffler ID:  
0383905900000Deep groove ball bearing 60, single row,  
steel sheet metal cage

★ Preferred product

## Technical information

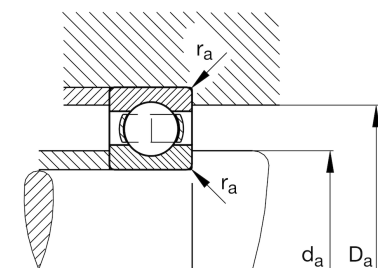
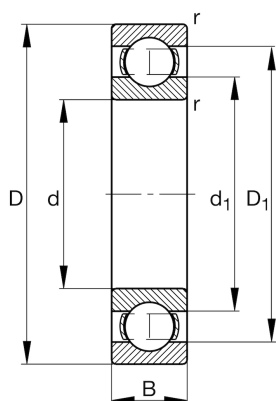

## Temperature range

$T_{\min}$	-30 °C	Operating temperature min.
$T_{\max}$	120 °C	Operating temperature max.
	8 g	Weight

## Main Dimensions &amp; Performance Data

d	7 mm	Bore diameter
D	19 mm	Outside diameter
B	6 mm	Width
$C_r$	2.340 N	Basic dynamic load rating, radial
$C_{0r}$	889 N	Basic static load rating, radial
$C_{ur}$	46,5 N	Fatigue load limit, radial
$n_G$	45.500 1/min	Limiting speed
$n_{gr}$	37.000 1/min	Reference speed

## Dimensions

$r_{\min}$	0,3 mm	Minimum chamfer dimension
$D_1$	15,5 mm	Shoulder diameter outer ring
$d_1$	10,12 mm	Shoulder diameter inner ring

## Mounting dimensions

$d_{a\min}$	9 mm	Minimum diameter shaft shoulder
$D_{a\max}$	17 mm	Maximum diameter of housing shoulder
$r_{a\max}$	0,3 mm	Maximum fillet radius

## Calculation factors

$f_0$	12,1	Calculation factor
-------	------	--------------------