

FAG

## ★ 6018-2RSR

Deep groove ball bearing

Schaeffler ID:  
0167182750000Deep groove ball bearing 60...-2RSR,  
single row, seals, steel sheet metal cage

★ Preferred product

## Technical information

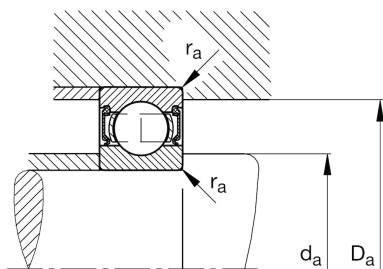
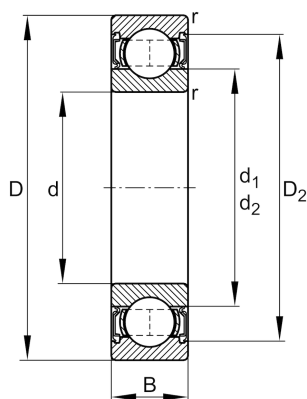

## Temperature range

$T_{\min}$	-20 °C	Operating temperature min.
$T_{\max}$	110 °C	Operating temperature max.
	1,21 kg	Weight

## Main Dimensions &amp; Performance Data

d	90 mm	Bore diameter
D	140 mm	Outside diameter
B	24 mm	Width
$C_r$	62.000 N	Basic dynamic load rating, radial
$C_{0r}$	49.500 N	Basic static load rating, radial
$C_{ur}$	3.000 N	Fatigue load limit, radial
$n_G$	2.500 1/min	Limiting speed

## Dimensions

$r_{\min}$	1,5 mm	Minimum chamfer dimension
$D_2$	126,8 mm	Caliber diameter outer ring
$d_1$	106,2 mm	Shoulder diameter inner ring

## Mounting dimensions

$d_{a \min}$	97 mm	Minimum diameter shaft shoulder
$D_{a \max}$	133 mm	Maximum diameter of housing shoulder
$r_{a \max}$	1,5 mm	Maximum fillet radius

## Calculation factors

$f_0$	15,5	Calculation factor
-------	------	--------------------