

FAG

★ 6024-2RSR

Deep groove ball bearing

Schaeffler ID:
0167184880000Deep groove ball bearing 60...-2RSR,
single row, seals, steel sheet metal cage

★ Preferred product

Technical information

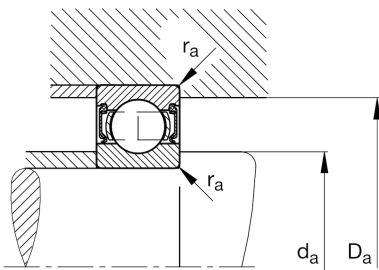
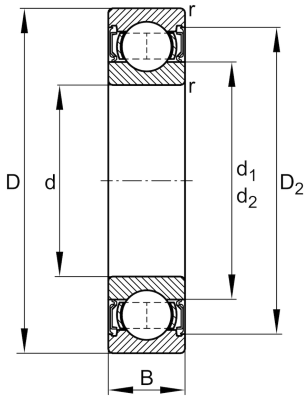

Temperature range

T_{\min}	-20 °C	Operating temperature min.
T_{\max}	110 °C	Operating temperature max.
	2,21 kg	Weight

Main Dimensions & Performance Data

d	120 mm	Bore diameter
D	180 mm	Outside diameter
B	28 mm	Width
C_r	88.000 N	Basic dynamic load rating, radial
C_{0r}	77.000 N	Basic static load rating, radial
C_{ur}	3.650 N	Fatigue load limit, radial
n_G	1.920 1/min	Limiting speed

Dimensions

r_{\min}	2 mm	Minimum chamfer dimension
D_2	165,4 mm	Caliber diameter outer ring
d_1	139,4 mm	Shoulder diameter inner ring

Mounting dimensions

$d_{a\min}$	128,8 mm	Minimum diameter shaft shoulder
$D_{a\max}$	171,2 mm	Maximum diameter of housing shoulder
$r_{a\max}$	2 mm	Maximum fillet radius

Calculation factors

f_0	15,8	Calculation factor
-------	------	--------------------