

FAG

★ 61809-Y

Deep groove ball bearing

Schaeffler ID:
0096193720000

Deep groove ball bearing 618..-Y, single row, brass sheet metal cage

★ Preferred product

Technical information

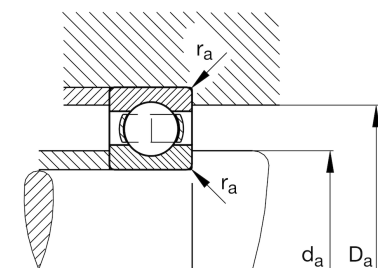
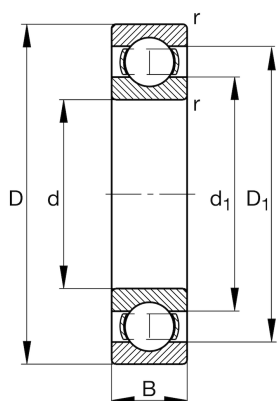

Temperature range

T_{\min}	-30 °C	Operating temperature min.
T_{\max}	120 °C	Operating temperature max.
	0,039 kg	Weight

Main Dimensions & Performance Data

d	45 mm	Bore diameter
D	58 mm	Outside diameter
B	7 mm	Width
C_r	7.000 N	Basic dynamic load rating, radial
C_{0r}	5.900 N	Basic static load rating, radial
C_{ur}	400 N	Fatigue load limit, radial
n_G	21.900 1/min	Limiting speed
n_{gr}	7.300 1/min	Reference speed

Dimensions

r_{\min}	0,3 mm	Minimum chamfer dimension
D_1	54,1 mm	Shoulder diameter outer ring
d_1	49,1 mm	Shoulder diameter inner ring

Mounting dimensions

$d_{a\min}$	47 mm	Minimum diameter shaft shoulder
$D_{a\max}$	56 mm	Maximum diameter of housing shoulder
$r_{a\max}$	0,3 mm	Maximum fillet radius

Calculation factors

f_0	16,3	Calculation factor
-------	------	--------------------