



FAG

★ 61817-Y

Deep groove ball bearing

Schaeffler ID:
0096197390000

Deep groove ball bearing 618..-Y, single row, brass sheet metal cage

★ Preferred product

Technical information

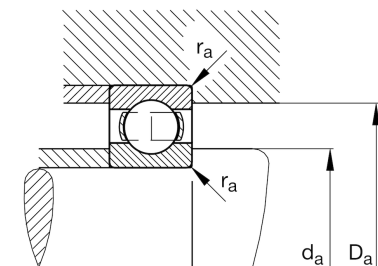
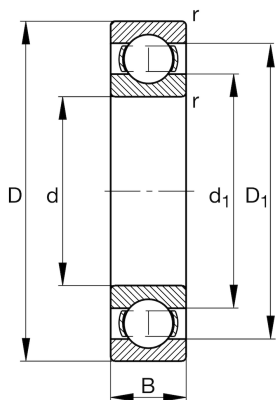

Temperature range

T_{\min}	-30 °C	Operating temperature min.
T_{\max}	150 °C	Operating temperature max.
	0,28 kg	Weight

Main Dimensions & Performance Data

d	85 mm	Bore diameter
D	110 mm	Outside diameter
B	13 mm	Width
C_r	20.400 N	Basic dynamic load rating, radial
C_{0r}	19.800 N	Basic static load rating, radial
C_{ur}	1.160 N	Fatigue load limit, radial
n_G	11.100 1/min	Limiting speed
n_{gr}	4.900 1/min	Reference speed

Dimensions

r_{\min}	1 mm	Minimum chamfer dimension
D_1	102 mm	Shoulder diameter outer ring
d_1	93,2 mm	Shoulder diameter inner ring

Mounting dimensions

$d_{a\min}$	89,6 mm	Minimum diameter shaft shoulder
$D_{a\max}$	105,4 mm	Maximum diameter of housing shoulder
$r_{a\max}$	1 mm	Maximum fillet radius

Calculation factors

f_0	16,2	Calculation factor
-------	------	--------------------