

FAG

★ 61856

Deep groove ball bearing

Schaeffler ID:
0384489800000Deep groove ball bearing 618, single row,
steel sheet metal cage

★ Preferred product

Technical information

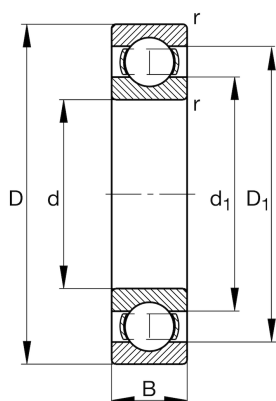

Temperature range

T_{\min}	-30 °C	Operating temperature min.
T_{\max}	200 °C	Operating temperature max.
	6,107 kg	Weight

Main Dimensions & Performance Data

d	280 mm	Bore diameter
D	350 mm	Outside diameter
B	33 mm	Width
C_r	129.000 N	Basic dynamic load rating, radial
C_{0r}	176.000 N	Basic static load rating, radial
C_{ur}	5.900 N	Fatigue load limit, radial
n_G	2.430 1/min	Limiting speed
n_{gr}	1.950 1/min	Reference speed

Dimensions

r_{\min}	2 mm	Minimum chamfer dimension
D_1	328,1 mm	Shoulder diameter outer ring
d_1	302,7 mm	Shoulder diameter inner ring

Mounting dimensions

$d_{a\min}$	288,8 mm	Minimum diameter shaft shoulder
$D_{a\max}$	341,2 mm	Maximum diameter of housing shoulder
$r_{a\max}$	2 mm	Maximum fillet radius

Calculation factors

f_0	16	Calculation factor
-------	----	--------------------