

FAG

6220-M

Deep groove ball bearing

Schaeffler ID:
0191058860000Deep groove ball bearing 62...-M, single
row, solid brass cage

Technical information

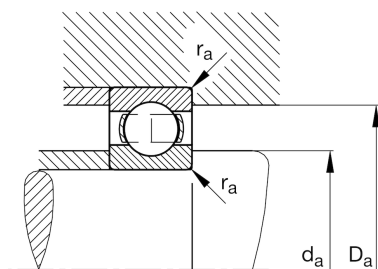
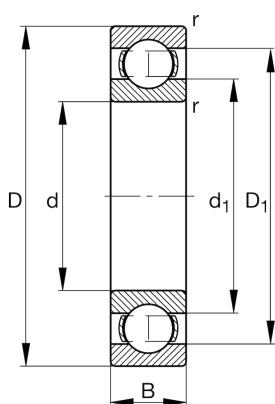
**Temperature range**

T_{\min}	-30 °C	Operating temperature min.
T_{\max}	150 °C	Operating temperature max.
	3,84 kg	Weight

Main Dimensions & Performance Data

d	100 mm	Bore diameter
D	180 mm	Outside diameter
B	34 mm	Width
C_r	130.000 N	Basic dynamic load rating, radial
C_{0r}	93.000 N	Basic static load rating, radial
C_{ur}	5.500 N	Fatigue load limit, radial
n_G	6.500 1/min	Limiting speed
n_{gr}	4.800 1/min	Reference speed

Dimensions

r_{\min}	2,1 mm	Minimum chamfer dimension
D_1	155,5 mm	Shoulder diameter outer ring
d_1	125,1 mm	Shoulder diameter inner ring

Mounting dimensions

$d_{a\min}$	112 mm	Minimum diameter shaft shoulder
$D_{a\max}$	168 mm	Maximum diameter of housing shoulder
$r_{a\max}$	2,1 mm	Maximum fillet radius

Calculation factors

f_0	14,4	Calculation factor
-------	------	--------------------