



FAG

## ★ 6226

## Deep groove ball bearing

Schaeffler ID:  
0167219770000Deep groove ball bearing 62, single row,  
steel sheet metal cage

★ Preferred product

## Technical information

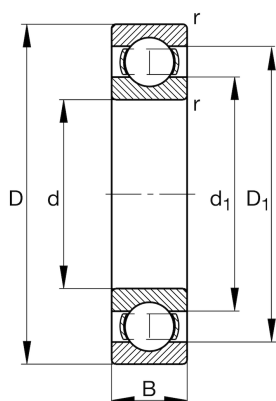

## Temperature range

$T_{\min}$	-30 °C	Operating temperature min.
$T_{\max}$	150 °C	Operating temperature max.
	6,24 kg	Weight

## Main Dimensions &amp; Performance Data

d	130 mm	Bore diameter
D	230 mm	Outside diameter
B	40 mm	Width
$C_r$	177.000 N	Basic dynamic load rating, radial
$C_{0r}$	146.000 N	Basic static load rating, radial
$C_{ur}$	7.700 N	Fatigue load limit, radial
$n_G$	3.850 1/min	Limiting speed
$n_{gr}$	3.900 1/min	Reference speed

## Dimensions

$r_{\min}$	3 mm	Minimum chamfer dimension
$D_1$	198,6 mm	Shoulder diameter outer ring
$d_1$	161,4 mm	Shoulder diameter inner ring

## Mounting dimensions

$d_{a\min}$	144 mm	Minimum diameter shaft shoulder
$D_{a\max}$	216 mm	Maximum diameter of housing shoulder
$r_{a\max}$	2,5 mm	Maximum fillet radius

## Calculation factors

$f_0$	14,5	Calculation factor
-------	------	--------------------