

FAG

## ★ 623

## Deep groove ball bearing

Schaeffler ID:  
0383908500000Deep groove ball bearing 62, single row,  
steel sheet metal cage

★ Preferred product

## Technical information

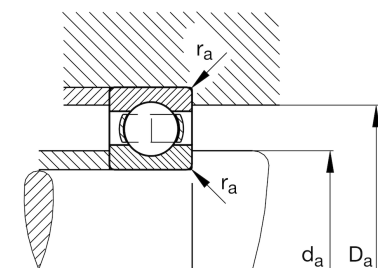
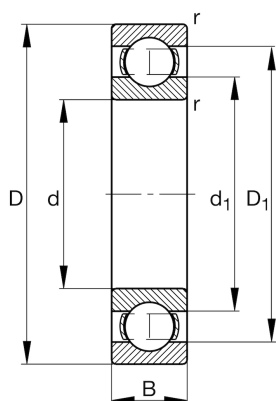

## Temperature range

$T_{\min}$	-30 °C	Operating temperature min.
$T_{\max}$	120 °C	Operating temperature max.
	2 g	Weight

## Main Dimensions &amp; Performance Data

d	3 mm	Bore diameter
D	10 mm	Outside diameter
B	4 mm	Width
$C_r$	670 N	Basic dynamic load rating, radial
$C_{0r}$	218 N	Basic static load rating, radial
$C_{ur}$	11,7 N	Fatigue load limit, radial
$n_G$	95.000 1/min	Limiting speed
$n_{gr}$	59.000 1/min	Reference speed

## Dimensions

$r_{\min}$	0,15 mm	Minimum chamfer dimension
$D_1$	7,08 mm	Shoulder diameter outer ring
$d_1$	4,8 mm	Shoulder diameter inner ring

## Mounting dimensions

$d_{a \min}$	4,4 mm	Minimum diameter shaft shoulder
$D_{a \max}$	8,6 mm	Maximum diameter of housing shoulder
$r_{a \max}$	0,15 mm	Maximum fillet radius

## Calculation factors

$f_0$	12,3	Calculation factor
-------	------	--------------------