

FAG

★ 6238-M

Deep groove ball bearing

Schaeffler ID:
0191067340000Deep groove ball bearing 62...-M, single
row, solid brass cage

★ Preferred product

Technical information

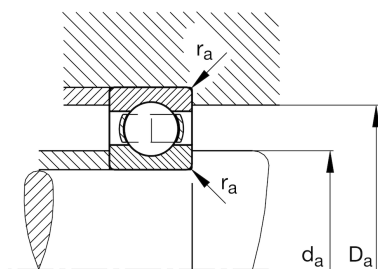
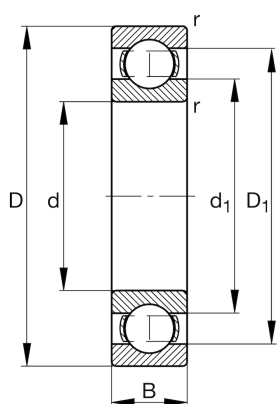

Temperature range

T_{\min}	-30 °C	Operating temperature min.
T_{\max}	200 °C	Operating temperature max.
	22,295 kg	Weight

Main Dimensions & Performance Data

d	190 mm	Bore diameter
D	340 mm	Outside diameter
B	55 mm	Width
C_r	255.000 N	Basic dynamic load rating, radial
C_{0r}	280.000 N	Basic static load rating, radial
C_{ur}	12.000 N	Fatigue load limit, radial
n_G	3.350 1/min	Limiting speed
n_{gr}	2.600 1/min	Reference speed

Dimensions

r_{\min}	4 mm	Minimum chamfer dimension
D_1	291,5 mm	Shoulder diameter outer ring
d_1	239,9 mm	Shoulder diameter inner ring

Mounting dimensions

$d_{a\min}$	207 mm	Minimum diameter shaft shoulder
$D_{a\max}$	323 mm	Maximum diameter of housing shoulder
$r_{a\max}$	3 mm	Maximum fillet radius

Calculation factors

f_0	14,9	Calculation factor
-------	------	--------------------