

FAG

★ 6240-M

Deep groove ball bearing

Schaeffler ID:
0191068150000Deep groove ball bearing 62...-M, single
row, solid brass cage

★ Preferred product

Technical information

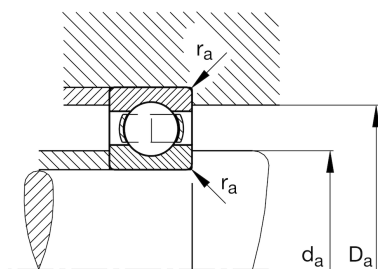
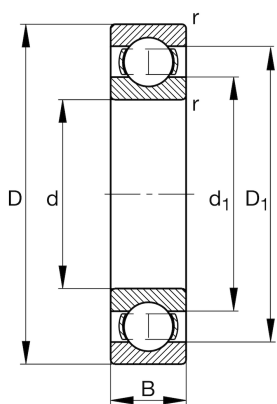

Temperature range

T_{\min}	-30 °C	Operating temperature min.
T_{\max}	200 °C	Operating temperature max.
	27 kg	Weight

Main Dimensions & Performance Data

d	200 mm	Bore diameter
D	360 mm	Outside diameter
B	58 mm	Width
C_r	270.000 N	Basic dynamic load rating, radial
C_{0r}	310.000 N	Basic static load rating, radial
C_{ur}	12.800 N	Fatigue load limit, radial
n_G	3.200 1/min	Limiting speed
n_{gr}	2.430 1/min	Reference speed

Dimensions

r_{\min}	4 mm	Minimum chamfer dimension
D_1	306,5 mm	Shoulder diameter outer ring
d_1	254,9 mm	Shoulder diameter inner ring

Mounting dimensions

$d_{a \min}$	217 mm	Minimum diameter shaft shoulder
$D_{a \max}$	343 mm	Maximum diameter of housing shoulder
$r_{a \max}$	3 mm	Maximum fillet radius

Calculation factors

f_0	15,2	Calculation factor
-------	------	--------------------