

FAG

★ 6217-2Z

Deep groove ball bearing

Schaeffler ID:
0167214620000Deep groove ball bearing 62...-2Z, single
row, shields, steel sheet metal cage

★ Preferred product

Technical information

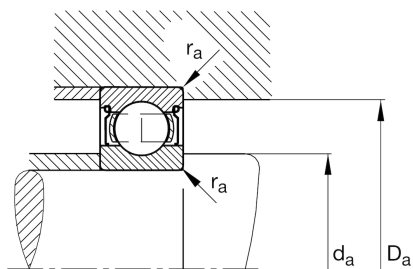
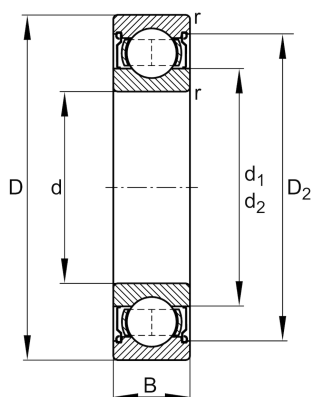

Temperature range

T_{\min}	-20 °C	Operating temperature min.
T_{\max}	120 °C	Operating temperature max.
	1,86 kg	Weight

Main Dimensions & Performance Data

d	85 mm	Bore diameter
D	150 mm	Outside diameter
B	28 mm	Width
C_r	89.000 N	Basic dynamic load rating, radial
C_{0r}	64.000 N	Basic static load rating, radial
C_{ur}	4.050 N	Fatigue load limit, radial
n_G	5.700 1/min	Limiting speed
n_{gr}	5.300 1/min	Reference speed

Dimensions

r_{\min}	2 mm	Minimum chamfer dimension
D_2	133,8 mm	Caliber diameter outer ring
d_1	106,2 mm	Shoulder diameter inner ring

Mounting dimensions

$d_{a \min}$	96 mm	Minimum diameter shaft shoulder
$D_{a \max}$	139 mm	Maximum diameter of housing shoulder
$r_{a \max}$	2 mm	Maximum fillet radius

Calculation factors

f_0	14,8	Calculation factor
-------	------	--------------------