

**FAG**★ **623-2Z**

Deep groove ball bearing

Schaeffler ID:
0383908680000

Deep groove ball bearing 62...-2Z, single row, shields, steel sheet metal cage

★ Preferred product

Technical information

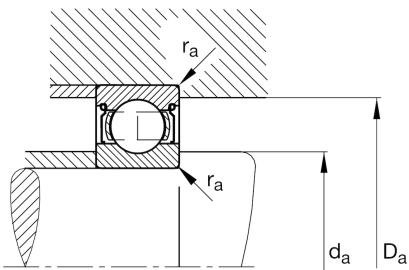
**Temperature range**

T_{\min}	-30 °C	Operating temperature min.
T_{\max}	120 °C	Operating temperature max.
	2 g	Weight

Main Dimensions & Performance Data

d	3 mm	Bore diameter
D	10 mm	Outside diameter
B	4 mm	Width
C_r	670 N	Basic dynamic load rating, radial
C_{0r}	218 N	Basic static load rating, radial
C_{ur}	11,7 N	Fatigue load limit, radial
n_G	81.000 1/min	Limiting speed
n_{gr}	59.000 1/min	Reference speed

Dimensions

r_{\min}	0,15 mm	Minimum chamfer dimension
D_2	7,98 mm	Caliber diameter outer ring
d_2	4,35 mm	Caliber diameter inner ring

Mounting dimensions

$d_{a\min}$	4,4 mm	Minimum diameter shaft shoulder
$D_{a\max}$	8,6 mm	Maximum diameter of housing shoulder
$r_{a\max}$	0,15 mm	Maximum fillet radius

Calculation factors

f_0	12,3	Calculation factor
-------	------	--------------------