

FAG

★ 62304-A-2RSR

Deep groove ball bearing

Schaeffler ID:
0596798750000Deep groove ball bearing 623..-A-2RSR,
single row, steel sheet metal cage

★ Preferred product

Technical information

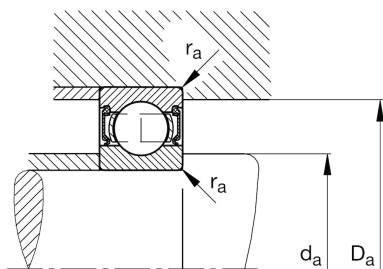
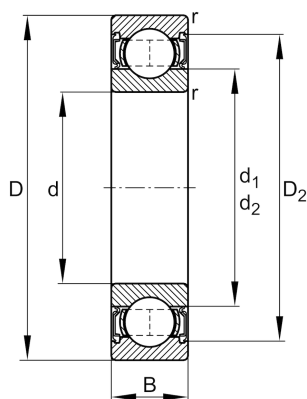

Temperature range

T_{\min}	-20 °C	Operating temperature min.
T_{\max}	110 °C	Operating temperature max.
	0,2 kg	Weight

Main Dimensions & Performance Data

d	20 mm	Bore diameter
D	52 mm	Outside diameter
B	21 mm	Width
C_r	16.900 N	Basic dynamic load rating, radial
C_{0r}	7.900 N	Basic static load rating, radial
C_{ur}	560 N	Fatigue load limit, radial
n_G	8.900 1/min	Limiting speed

Dimensions

r_{\min}	1,1 mm	Minimum chamfer dimension
D_2	45,1 mm	Caliber diameter outer ring
d_1	30 mm	Shoulder diameter inner ring

Mounting dimensions

$d_{a \min}$	27 mm	Minimum diameter shaft shoulder
$D_{a \max}$	45 mm	Maximum diameter of housing shoulder
$r_{a \max}$	1,1 mm	Maximum fillet radius

Calculation factors

f_0	12,4	Calculation factor
-------	------	--------------------