

FAG

★ 62310-2RSR

Deep groove ball bearing

Schaeffler ID:
0167221750000Deep groove ball bearing 623...-2RSR,
single row, seals, steel sheet metal cage

★ Preferred product

Technical information

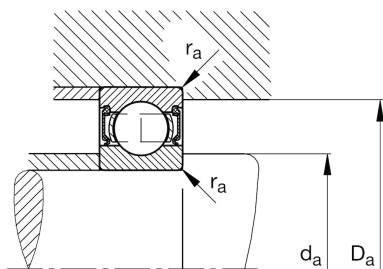
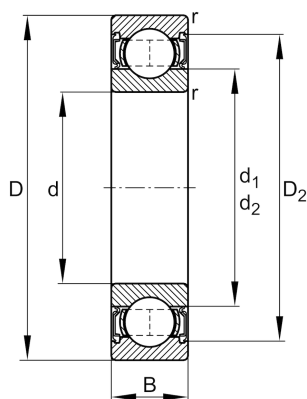

Temperature range

| | | |
|------------|---------|----------------------------|
| T_{\min} | -20 °C | Operating temperature min. |
| T_{\max} | 110 °C | Operating temperature max. |
| | 1,55 kg | Weight |

Main Dimensions & Performance Data

| | | |
|----------|-------------|-----------------------------------|
| d | 50 mm | Bore diameter |
| D | 110 mm | Outside diameter |
| B | 40 mm | Width |
| C_r | 66.000 N | Basic dynamic load rating, radial |
| C_{0r} | 38.000 N | Basic static load rating, radial |
| C_{ur} | 2.700 N | Fatigue load limit, radial |
| n_G | 3.950 1/min | Limiting speed |

Dimensions

| | | |
|------------|---------|------------------------------|
| r_{\min} | 2 mm | Minimum chamfer dimension |
| D_2 | 95,1 mm | Caliber diameter outer ring |
| d_1 | 68 mm | Shoulder diameter inner ring |

Mounting dimensions

| | | |
|-------------|-------|--------------------------------------|
| $d_{a\min}$ | 61 mm | Minimum diameter shaft shoulder |
| $D_{a\max}$ | 99 mm | Maximum diameter of housing shoulder |
| $r_{a\max}$ | 2 mm | Maximum fillet radius |

Calculation factors

| | | |
|-------|------|--------------------|
| f_0 | 13,1 | Calculation factor |
|-------|------|--------------------|