

FAG

★ 6330-M

Deep groove ball bearing

Schaeffler ID:
0191120840000Deep groove ball bearing 63...-M, single
row, solid brass cage

★ Preferred product

Technical information

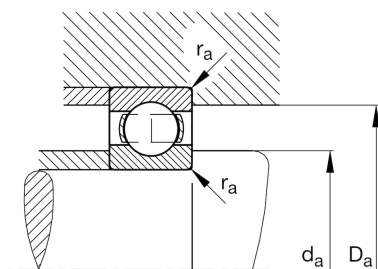
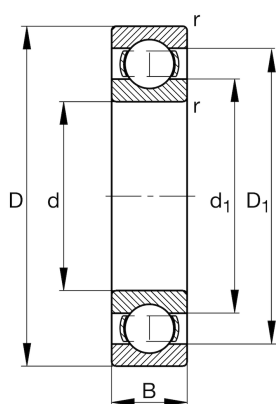

Temperature range

T_{min}	-30 °C	Operating temperature min.
T_{max}	200 °C	Operating temperature max.
	26,5 kg	Weight

Main Dimensions & Performance Data

d	150 mm	Bore diameter
D	320 mm	Outside diameter
B	65 mm	Width
C_r	300.000 N	Basic dynamic load rating, radial
C_{0r}	290.000 N	Basic static load rating, radial
C_{ur}	13.500 N	Fatigue load limit, radial
n_G	3.600 1/min	Limiting speed
n_{gr}	3.000 1/min	Reference speed

Dimensions

r_{min}	4 mm	Minimum chamfer dimension
D_1	266,2 mm	Shoulder diameter outer ring
d_1	205,5 mm	Shoulder diameter inner ring

Mounting dimensions

$d_{a min}$	167 mm	Minimum diameter shaft shoulder
$D_{a max}$	303 mm	Maximum diameter of housing shoulder
$r_{a max}$	3 mm	Maximum fillet radius

Calculation factors

f_0	13,7	Calculation factor
-------	------	--------------------