

FAG

6336-M

Deep groove ball bearing

Schaeffler ID:
0191122110000Deep groove ball bearing 63.-M, single
row, solid brass cage

Technical information

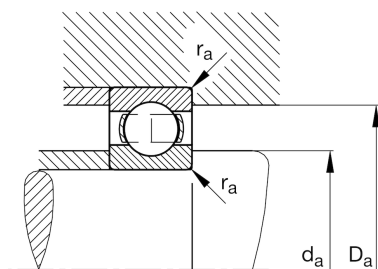
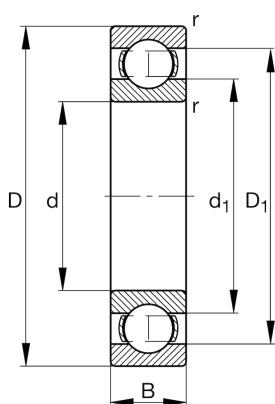
**Temperature range**

T_{\min}	-30 °C	Operating temperature min.
T_{\max}	200 °C	Operating temperature max.
	43 kg	Weight

Main Dimensions & Performance Data

d	180 mm	Bore diameter
D	380 mm	Outside diameter
B	75 mm	Width
C_r	355.000 N	Basic dynamic load rating, radial
C_{0r}	405.000 N	Basic static load rating, radial
C_{ur}	16.800 N	Fatigue load limit, radial
n_G	3.000 1/min	Limiting speed
n_{gr}	2.440 1/min	Reference speed

Dimensions

r_{\min}	4 mm	Minimum chamfer dimension
D_1	317 mm	Shoulder diameter outer ring
d_1	245,2 mm	Shoulder diameter inner ring

Mounting dimensions

$d_{a\min}$	197 mm	Minimum diameter shaft shoulder
$D_{a\max}$	363 mm	Maximum diameter of housing shoulder
$r_{a\max}$	3 mm	Maximum fillet radius

Calculation factors

f_0	13,8	Calculation factor
-------	------	--------------------