

FAG

6338-M

Deep groove ball bearing

Schaeffler ID:
0191122460000Deep groove ball bearing 63.-M, single
row, solid brass cage

Technical information

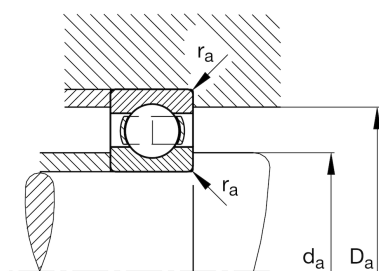
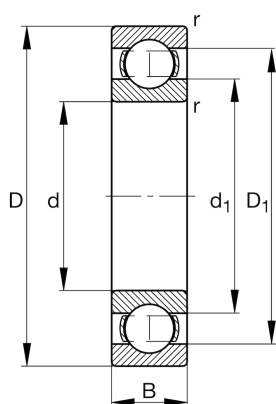
**Temperature range**

T_{\min}	-30 °C	Operating temperature min.
T_{\max}	200 °C	Operating temperature max.
	50,4 kg	Weight

Main Dimensions & Performance Data

d	190 mm	Bore diameter
D	400 mm	Outside diameter
B	78 mm	Width
C_r	370.000 N	Basic dynamic load rating, radial
C_{0r}	435.000 N	Basic static load rating, radial
C_{ur}	18.000 N	Fatigue load limit, radial
n_G	2.850 1/min	Limiting speed
n_{gr}	2.300 1/min	Reference speed

Dimensions

r_{\min}	5 mm	Minimum chamfer dimension
D_1	330,5 mm	Shoulder diameter outer ring
d_1	260,2 mm	Shoulder diameter inner ring

Mounting dimensions

$d_{a\min}$	210 mm	Minimum diameter shaft shoulder
$D_{a\max}$	380 mm	Maximum diameter of housing shoulder
$r_{a\max}$	4 mm	Maximum fillet radius

Calculation factors

f_0	13,9	Calculation factor
-------	------	--------------------