

FAG

★ 6306-2RSR

Deep groove ball bearing

Schaeffler ID:
0167231040000Deep groove ball bearing 63...-2RSR,
single row, seals, steel sheet metal cage

★ Preferred product

Technical information

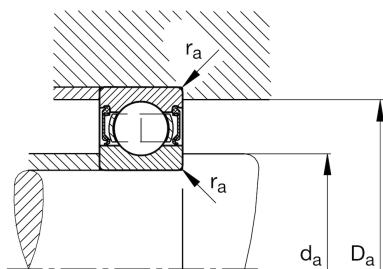
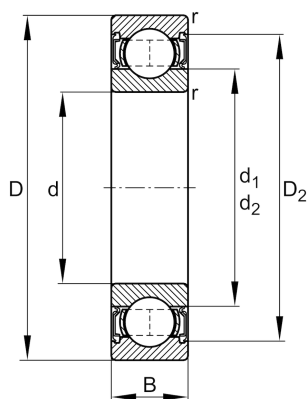

Temperature range

T_{\min}	-20 °C	Operating temperature min.
T_{\max}	110 °C	Operating temperature max.
	0,35 kg	Weight

Main Dimensions & Performance Data

d	30 mm	Bore diameter
D	72 mm	Outside diameter
B	19 mm	Width
C_r	30.500 N	Basic dynamic load rating, radial
C_{0r}	16.200 N	Basic static load rating, radial
C_{ur}	1.050 N	Fatigue load limit, radial
n_G	6.000 1/min	Limiting speed

Dimensions

r_{\min}	1,1 mm	Minimum chamfer dimension
D_2	61,6 mm	Caliber diameter outer ring
d_1	44,6 mm	Shoulder diameter inner ring

Mounting dimensions

$d_{a\min}$	37 mm	Minimum diameter shaft shoulder
$D_{a\max}$	65 mm	Maximum diameter of housing shoulder
$r_{a\max}$	1,1 mm	Maximum fillet radius

Calculation factors

f_0	13	Calculation factor
-------	----	--------------------