

FAG

## ★ 11212-TVH

Self-aligning ball bearing

Schaeffler ID:  
0167001980000

Self-aligning ball bearing 112...-TVH, plastic cage

★ Preferred product

## Technical information

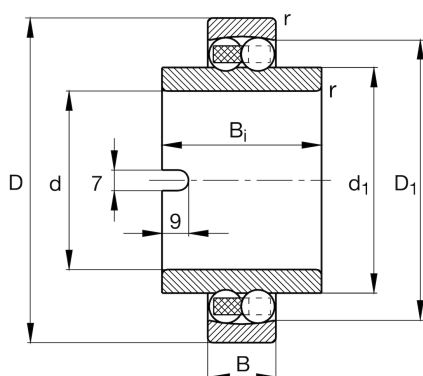
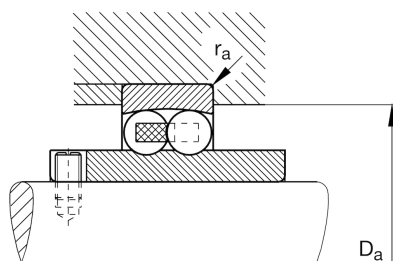

## Main Dimensions &amp; Performance Data

d	60 mm	Bore diameter
D	110 mm	Outside diameter
B	22 mm	Width, outer ring
B <sub>i</sub>	62 mm	Width, inner ring
r <sub>min</sub>	1,5 mm	Minimum chamfer dimension
C <sub>r</sub>	30.500 N	Basic dynamic load rating, radial
C <sub>0r</sub>	11.500 N	Basic static load rating, radial
C <sub>ur</sub>	730 N	Fatigue load limit, radial
n <sub>G</sub>	6.900 1/min	Limiting speed
n <sub>gr</sub>	6.300 1/min	Reference speed
	1,54 kg	Weight

## Dimensions

D <sub>1</sub>	95,2 mm	Shoulder diameter outer ring
d <sub>1</sub>	78 mm	Shoulder diameter inner ring
b	7 mm	Width retaining slot
t	9 mm	Height retaining slot

## Mounting dimensions

D <sub>a max</sub>	101 mm	Maximum diameter of housing shoulder
r <sub>a max</sub>	1,5 mm	Maximaler Hohlkehlradius

## Calculation factors

e	0,18	Limiting value of Fa/Fr for the applicability of diff. Values of factors X and Y
Y <sub>1</sub>	3,47	Dynamic axial load factor
Y <sub>2</sub>	5,37	Dynamic axial load factor
Y <sub>0</sub>	3,64	Static axial load factor