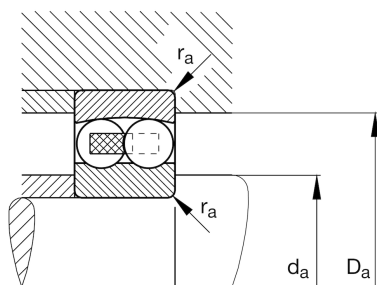
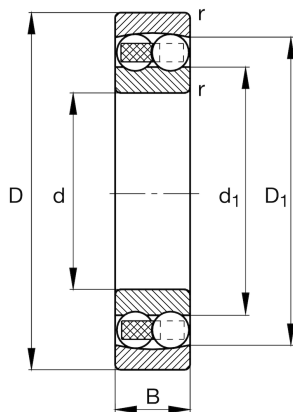

FAG**1312-TVH**

Self-aligning ball bearing

Schaeffler ID:
0167008210000Self-aligning ball bearing 13..-TVH, plastic
cage

Technical information

**Main Dimensions & Performance Data**

d	60 mm	Bore diameter
D	130 mm	Outside diameter
B	31 mm	Width
r_{min}	2,1 mm	Minimum chamfer dimension
C_r	58.000 N	Basic dynamic load rating, radial
C_{0r}	20.800 N	Basic static load rating, radial
C_{ur}	1.320 N	Fatigue load limit, radial
n_G	5.500 1/min	Limiting speed
n_{gr}	5.200 1/min	Reference speed
	1,96 kg	Weight

Dimensions

D_1	112,2 mm	Shoulder diameter outer ring
d_1	87 mm	Shoulder diameter inner ring

Mounting dimensions

d_{amin}	72 mm	Minimum diameter shaft shoulder
D_{amax}	118 mm	Maximum diameter of housing shoulder
r_{amax}	2,1 mm	Maximum fillet radius

Calculation factors

e	0,23	Limiting value of F_a/F_r for the applicability of diff. Values of factors X and Y
Y_1	2,78	Dynamic axial load factor
Y_2	4,3	Dynamic axial load factor
Y_0	2,91	Static axial load factor

Temperature range

T_{min}	-30 °C	Operating temperature min.
T_{max}	120 °C	Operating temperature max.