

FAG★ **2306-2RS-TVH**

Self-aligning ball bearing

Schaeffler ID:
0167070600000Self-aligning ball bearing 23...-2RS-TVH,
seals, plastic cage

★ Preferred product

Technical information

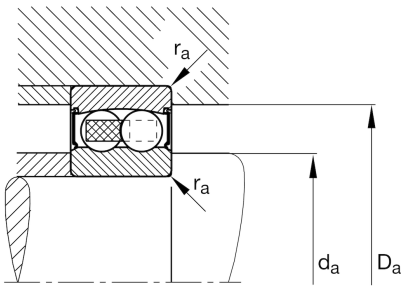
**Temperature range**

T_{\min}	-20 °C	Operating temperature min.
T_{\max}	100 °C	Operating temperature max.
	0,514 kg	Weight

Main Dimensions & Performance Data

d	30 mm	Bore diameter
D	72 mm	Outside diameter
B	27 mm	Width
r_{\min}	1,1 mm	Minimum chamfer dimension
C_r	21.700 N	Basic dynamic load rating, radial
C_{0r}	6.300 N	Basic static load rating, radial
C_{ur}	400 N	Fatigue load limit, radial
n_G	5.900 1/min	Limiting speed

Dimensions

D_2	62,3 mm	Caliber diameter outer ring
d_2	40,6 mm	Caliber diameter inner ring

Mounting dimensions

$d_{a\min}$	37 mm	Minimum diameter shaft shoulder
$D_{a\max}$	65 mm	Maximum diameter of housing shoulder
$r_{a\max}$	1 mm	Maximum fillet radius

Calculation factors

e	0,26	Limiting value of F_a/F_r for the applicability of diff. Values of factors X and Y
Y_1	2,41	Dynamic axial load factor
Y_2	3,72	Dynamic axial load factor
Y_0	2,52	Static axial load factor