

FAG

HS7000-C-T-P4S-UL

Angular contact ball bearing

Schaeffler ID:
0191839680000Spindle bearings HS70...-C, adjusted,
in pairs or sets, contact angle $\alpha = 15^\circ$,
restricted tolerances

Technical information

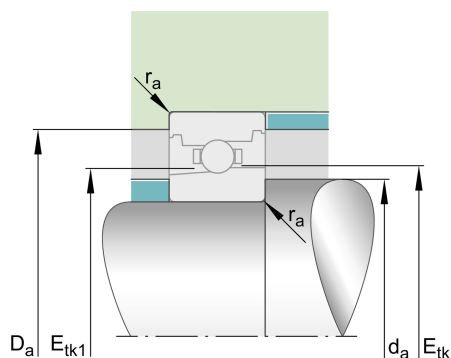
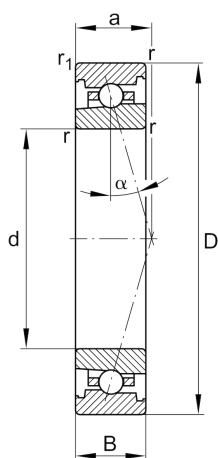
**Temperature range**

T_{min}	-30 °C	Operating temperature min.
T_{max}	100 °C	Operating temperature max.
	21 g	Weight

Main Dimensions & Performance Data

d	10 mm	Bore diameter
D	26 mm	Outside diameter
B	8 mm	Width
C_r	2.470 N	Basic dynamic load rating, radial
C_{0r}	940 N	Basic static load rating, radial
C_{ur}	99 N	Fatigue load limit, radial
$n_{G Grease}$	90.000 1/min	Limiting speed for grease lubrication
$n_{G Oil}$	140.000 1/min	Limiting speed for oil lubrication

Dimensions

r_{min}	0,3 mm	Minimum chamfer dimension
$r_{1 min}$	0,3 mm	Minimum chamfer dimension
α	15 °	Contact angle

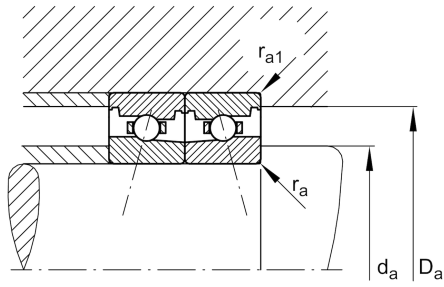

Mounting dimensions

d_a	14 mm	Diameter shaft shoulder
d_a	h12	Diameter shaft shoulder clearance
D_a	22 mm	Shoulder diameter outer ring
D_a	H12	Shoulder diameter outer ring clearance
$r_{a \max}$	0,3 mm	Maximum recess radius
$r_{a1 \max}$	0,1 mm	Maximum recess radius
$E_{tk \min}$	16,4 mm	Minimum diameter injection pitch
$E_{tk \max}$	16,9 mm	Maximum diameter injection pitch
$E_{tk1 \min}$	15,3 mm	Minimum diameter injection pitch
$E_{tk1 \max}$	16,9 mm	Maximum diameter injection pitch
a	6,4 mm	Distance between the apexes of the pressure cones

Additional information

F_{VL}	9 N	Preload force light
F_{VM}	28 N	Preload force medium
F_{VH}	55 N	Preload force heavy
K_{aEL}	28 N	Lift-off force light
K_{aEM}	89 N	Lift-off force medium
K_{aEH}	185 N	Lift-off force heavy
c_{aL}	10,9 N/ μ m	Axial rigidity light
c_{aM}	17,4 N/ μ m	Axial rigidity medium
c_{aH}	24,1 N/ μ m	Axial rigidity heavy