

FAG

**HS7002-C-T-P4S-UL**

Angular contact ball bearing

Schaeffler ID:  
0191839840000Spindle bearings HS70...-C, adjusted,  
in pairs or sets, contact angle  $\alpha = 15^\circ$ ,  
restricted tolerances

## Technical information

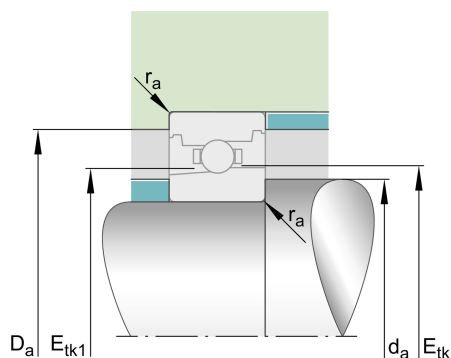
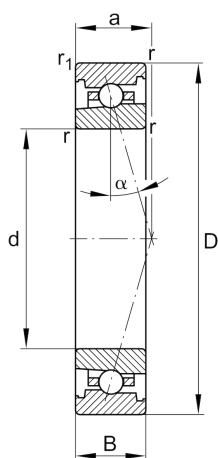
**Temperature range**

$T_{min}$	-30 °C	Operating temperature min.
$T_{max}$	100 °C	Operating temperature max.
	32 g	Weight

**Main Dimensions & Performance Data**

d	15 mm	Bore diameter
D	32 mm	Outside diameter
B	9 mm	Width
$C_r$	3.450 N	Basic dynamic load rating, radial
$C_{0r}$	1.480 N	Basic static load rating, radial
$C_{ur}$	157 N	Fatigue load limit, radial
$n_{G Grease}$	70.000 1/min	Limiting speed for grease lubrication
$n_{G Oil}$	110.000 1/min	Limiting speed for oil lubrication

**Dimensions**

$r_{min}$	0,3 mm	Minimum chamfer dimension
$r_{1 min}$	0,3 mm	Minimum chamfer dimension
$\alpha$	15 °	Contact angle

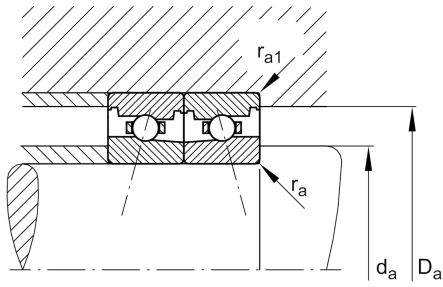
**Mounting dimensions**

$d_a$	19 mm	Diameter shaft shoulder
$d_a$	h12	Diameter shaft shoulder clearance
$D_a$	29 mm	Shoulder diameter outer ring
$D_a$	H12	Shoulder diameter outer ring clearance
$r_{a \max}$	0,3 mm	Maximum recess radius
$r_{a1 \max}$	0,1 mm	Maximum recess radius
$E_{tk \min}$	21,6 mm	Minimum diameter injection pitch
$E_{tk \max}$	22,4 mm	Maximum diameter injection pitch
$E_{tk1 \min}$	20,4 mm	Minimum diameter injection pitch
$E_{tk1 \max}$	22,4 mm	Maximum diameter injection pitch
$a$	7,6 mm	Distance between the apexes of the pressure cones

**Additional information**

$F_{VL}$	13 N	Preload force light
$F_{VM}$	38 N	Preload force medium
$F_{VH}$	75 N	Preload force heavy
$K_{aEL}$	38 N	Lift-off force light
$K_{aEM}$	120 N	Lift-off force medium
$K_{aEH}$	251 N	Lift-off force heavy
$c_{aL}$	13,7 N/ $\mu\text{m}$	Axial rigidity light
$c_{aM}$	21,8 N/ $\mu\text{m}$	Axial rigidity medium
$c_{aH}$	30,2 N/ $\mu\text{m}$	Axial rigidity heavy