

FAG

HS7003-C-T-P4S-UL

Angular contact ball bearing

Schaeffler ID:
0191839920000Spindle bearings HS70...-C, adjusted,
in pairs or sets, contact angle $\alpha = 15^\circ$,
restricted tolerances

Technical information

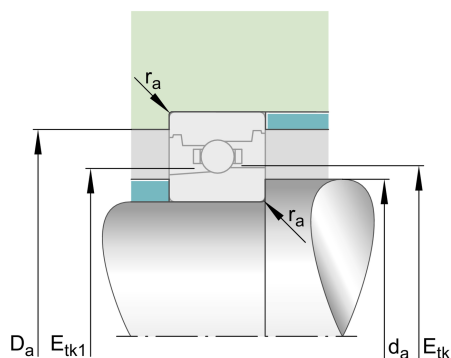
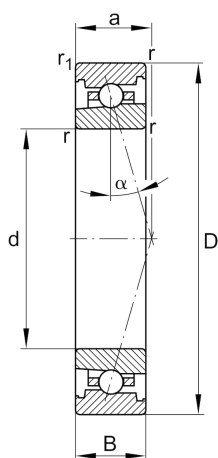
**Temperature range**

T_{\min}	-30 °C	Operating temperature min.
T_{\max}	100 °C	Operating temperature max.
	42 g	Weight

Main Dimensions & Performance Data

d	17 mm	Bore diameter
D	35 mm	Outside diameter
B	10 mm	Width
C_r	3.550 N	Basic dynamic load rating, radial
C_{0r}	1.600 N	Basic static load rating, radial
C_{ur}	170 N	Fatigue load limit, radial
$n_{G \text{ Grease}}$	63.000 1/min	Limiting speed for grease lubrication
$n_{G \text{ Oil}}$	95.000 1/min	Limiting speed for oil lubrication

Dimensions

r_{\min}	0,3 mm	Minimum chamfer dimension
$r_{1 \min}$	0,3 mm	Minimum chamfer dimension
α	15 °	Contact angle

