

FAG

★ HS7011-C-T-P4S-UL

Angular contact ball bearing

Schaeffler ID:
0191841660000

★ Preferred product

Spindle bearings HS70...-C, adjusted,
in pairs or sets, contact angle $\alpha = 15^\circ$,
restricted tolerances

Technical information

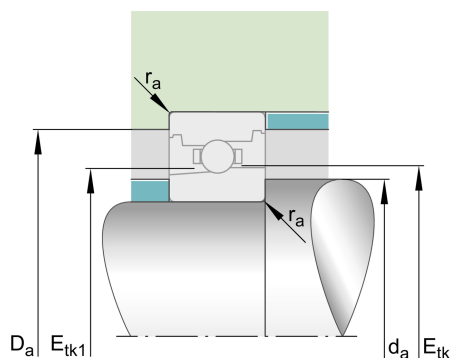
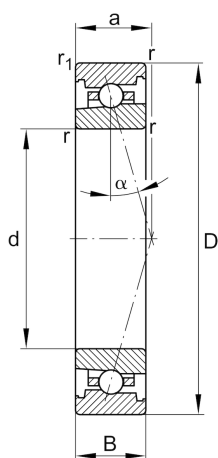

Temperature range

T_{\min}	-30 °C	Operating temperature min.
T_{\max}	100 °C	Operating temperature max.
	0,391 kg	Weight

Main Dimensions & Performance Data

d	55 mm	Bore diameter
D	90 mm	Outside diameter
B	18 mm	Width
C_r	17.900 N	Basic dynamic load rating, radial
C_{0r}	11.500 N	Basic static load rating, radial
C_{ur}	1.210 N	Fatigue load limit, radial
$n_{G \text{ Grease}}$	22.000 1/min	Limiting speed for grease lubrication
$n_{G \text{ Oil}}$	34.000 1/min	Limiting speed for oil lubrication

Dimensions

r_{\min}	1,1 mm	Minimum chamfer dimension
$r_{1 \min}$	1,1 mm	Minimum chamfer dimension
α	15 °	Contact angle

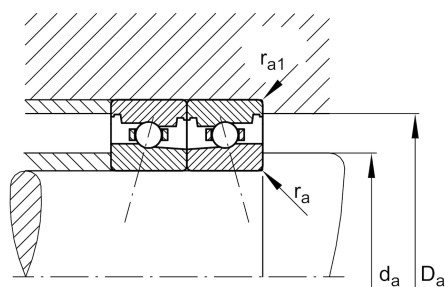

Mounting dimensions

d_a	62 mm	Diameter shaft shoulder
d_a	h12	Diameter shaft shoulder clearance
D_a	83 mm	Shoulder diameter outer ring
D_a	H12	Shoulder diameter outer ring clearance
$r_{a \max}$	1 mm	Maximum recess radius
$r_{a1 \max}$	0,6 mm	Maximum recess radius
$E_{tk \min}$	68,5 mm	Minimum diameter injection pitch
$E_{tk \max}$	70,3 mm	Maximum diameter injection pitch
$E_{tk1 \min}$	65,9 mm	Minimum diameter injection pitch
$E_{tk1 \max}$	70,3 mm	Maximum diameter injection pitch
a	18,7 mm	Distance between the apexes of the pressure cones

Additional information

F_{VL}	62 N	Preload force light
F_{VM}	187 N	Preload force medium
F_{VH}	374 N	Preload force heavy
K_{aEL}	187 N	Lift-off force light
K_{aEM}	588 N	Lift-off force medium
K_{aEH}	1.225 N	Lift-off force heavy
c_{aL}	42,2 N/ μm	Axial rigidity light
c_{aM}	66,5 N/ μm	Axial rigidity medium
c_{aH}	91,1 N/ μm	Axial rigidity heavy