

FAG

**HS7017-C-T-P4S-UL**

Angular contact ball bearing

Schaeffler ID:  
0191843360000Spindle bearings HS70...-C, adjusted,  
in pairs or sets, contact angle  $\alpha = 15^\circ$ ,  
restricted tolerances

## Technical information

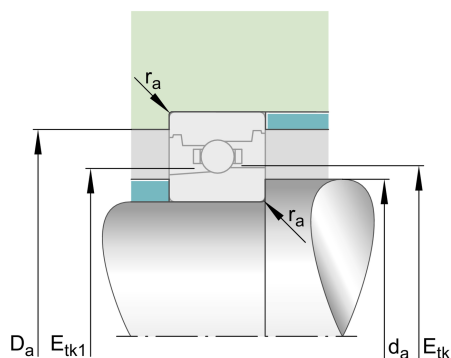
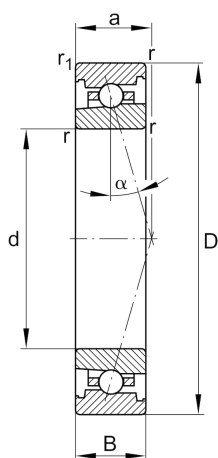
**Temperature range**

$T_{\min}$	-30 °C	Operating temperature min.
$T_{\max}$	100 °C	Operating temperature max.
	0,837 kg	Weight

**Main Dimensions & Performance Data**

d	85 mm	Bore diameter
D	130 mm	Outside diameter
B	22 mm	Width
$C_r$	30.500 N	Basic dynamic load rating, radial
$C_{0r}$	22.700 N	Basic static load rating, radial
$C_{ur}$	2.320 N	Fatigue load limit, radial
$n_{G \text{ Grease}}$	15.000 1/min	Limiting speed for grease lubrication
$n_{G \text{ Oil}}$	22.000 1/min	Limiting speed for oil lubrication

**Dimensions**

$r_{\min}$	1,1 mm	Minimum chamfer dimension
$r_{1 \min}$	1,1 mm	Minimum chamfer dimension
$\alpha$	15 °	Contact angle

### Mounting dimensions

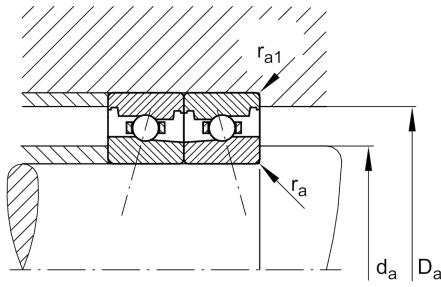

$d_a$	93 mm	Diameter shaft shoulder
$d_a$	h12	Diameter shaft shoulder clearance
$D_a$	122 mm	Shoulder diameter outer ring
$D_a$	H12	Shoulder diameter outer ring clearance
$r_{a \max}$	1 mm	Maximum recess radius
$r_{a1 \max}$	0,6 mm	Maximum recess radius
$E_{tk \min}$	102,3 mm	Minimum diameter injection pitch
$E_{tk \max}$	104,7 mm	Maximum diameter injection pitch
$E_{tk1 \min}$	99 mm	Minimum diameter injection pitch
$E_{tk1 \max}$	104,7 mm	Maximum diameter injection pitch
$a$	25,4 mm	Distance between the apexes of the pressure cones

### Additional information

$F_{VL}$	107 N	Preload force light
$F_{VM}$	322 N	Preload force medium
$F_{VH}$	643 N	Preload force heavy
$K_{aEL}$	320 N	Lift-off force light
$K_{aEM}$	1.006 N	Lift-off force medium
$K_{aEH}$	2.093 N	Lift-off force heavy
$c_{aL}$	60,3 N/ $\mu\text{m}$	Axial rigidity light
$c_{aM}$	94,4 N/ $\mu\text{m}$	Axial rigidity medium
$c_{aH}$	129 N/ $\mu\text{m}$	Axial rigidity heavy