

FAG

## ★ HS7018-C-T-P4S-UL

Angular contact ball bearing

Schaeffler ID:  
0191843600000Spindle bearings HS70...-C, adjusted,  
in pairs or sets, contact angle  $\alpha = 15^\circ$ ,  
restricted tolerances

★ Preferred product

## Technical information

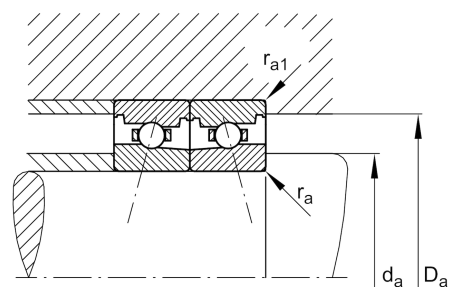
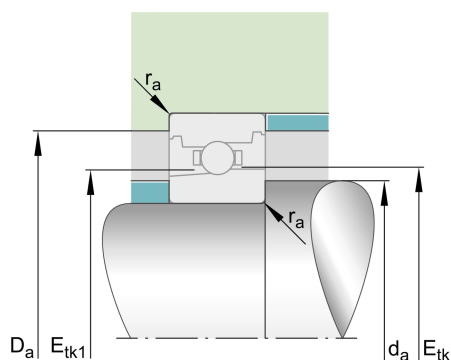
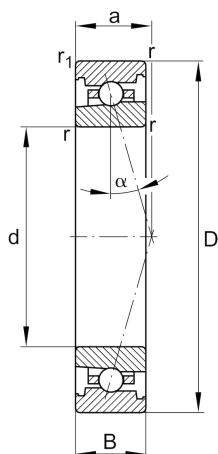

## Temperature range

$T_{\min}$	-30 °C	Operating temperature min.
$T_{\max}$	100 °C	Operating temperature max.
	1,198 kg	Weight

## Main Dimensions &amp; Performance Data

d	90 mm	Bore diameter
D	140 mm	Outside diameter
B	24 mm	Width
$C_r$	36.000 N	Basic dynamic load rating, radial
$C_{0r}$	26.500 N	Basic static load rating, radial
$C_{ur}$	2.600 N	Fatigue load limit, radial
$n_{G \text{ Grease}}$	14.000 1/min	Limiting speed for grease lubrication
$n_{G \text{ Oil}}$	22.000 1/min	Limiting speed for oil lubrication

## Dimensions

$r_{\min}$	1,5 mm	Minimum chamfer dimension
$r_{1 \min}$	1,5 mm	Minimum chamfer dimension
$\alpha$	15 °	Contact angle

## Mounting dimensions

$d_a$	100 mm	Diameter shaft shoulder
$d_a$	h12	Diameter shaft shoulder clearance
$D_a$	131 mm	Shoulder diameter outer ring
$D_a$	H12	Shoulder diameter outer ring clearance
$r_{a \max}$	1,5 mm	Maximum recess radius
$r_{a1 \max}$	0,6 mm	Maximum recess radius
$E_{tk \min}$	109,3 mm	Minimum diameter injection pitch
$E_{tk \max}$	111,9 mm	Maximum diameter injection pitch
$E_{tk1 \min}$	105,7 mm	Minimum diameter injection pitch
$E_{tk1 \max}$	111,9 mm	Maximum diameter injection pitch
a	27,4 mm	Distance between the apexes of the pressure cones

**Additional information**

$F_{VL}$	126 N	Preload force light
$F_{VM}$	377 N	Preload force medium
$F_{VH}$	754 N	Preload force heavy
$K_{aEL}$	375 N	Lift-off force light
$K_{aEM}$	1.178 N	Lift-off force medium
$K_{aEH}$	2.451 N	Lift-off force heavy
$c_{aL}$	65,4 N/ $\mu\text{m}$	Axial rigidity light
$c_{aM}$	102 N/ $\mu\text{m}$	Axial rigidity medium
$c_{aH}$	140 N/ $\mu\text{m}$	Axial rigidity heavy