

FAG

★ HS7024-C-T-P4S-UL

Angular contact ball bearing

Schaeffler ID:
0191844500000

★ Preferred product

Spindle bearings HS70...-C, adjusted,
in pairs or sets, contact angle $\alpha = 15^\circ$,
restricted tolerances

Technical information

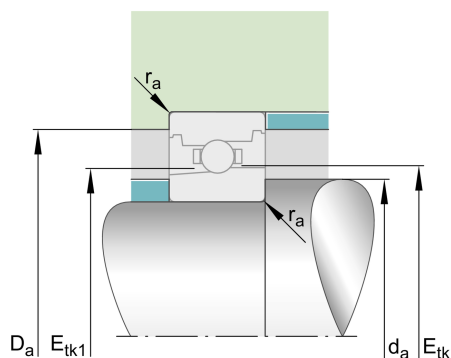
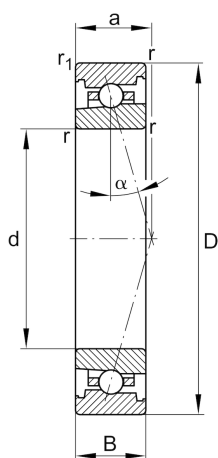

Temperature range

T_{\min}	-30 °C	Operating temperature min.
T_{\max}	100 °C	Operating temperature max.
	2,22 kg	Weight

Main Dimensions & Performance Data

d	120 mm	Bore diameter
D	180 mm	Outside diameter
B	28 mm	Width
C_r	49.500 N	Basic dynamic load rating, radial
C_{0r}	40.500 N	Basic static load rating, radial
C_{ur}	3.500 N	Fatigue load limit, radial
$n_{G \text{ Grease}}$	10.000 1/min	Limiting speed for grease lubrication
$n_{G \text{ Oil}}$	16.000 1/min	Limiting speed for oil lubrication

Dimensions

r_{\min}	2 mm	Minimum chamfer dimension
$r_{1 \min}$	2 mm	Minimum chamfer dimension
α	15 °	Contact angle

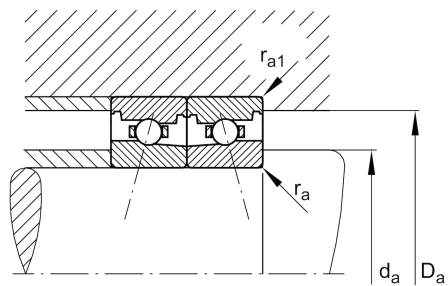

Mounting dimensions

d_a	131 mm	Diameter shaft shoulder
d_a	h12	Diameter shaft shoulder clearance
D_a	169 mm	Shoulder diameter outer ring
D_a	H12	Shoulder diameter outer ring clearance
$r_{a\max}$	2 mm	Maximum recess radius
$r_{a1\max}$	1 mm	Maximum recess radius
$E_{tk\min}$	143,3 mm	Minimum diameter injection pitch
$E_{tk\max}$	146,4 mm	Maximum diameter injection pitch
$E_{tk1\min}$	139,2 mm	Minimum diameter injection pitch
$E_{tk1\max}$	146,4 mm	Maximum diameter injection pitch
a	34,1 mm	Distance between the apexes of the pressure cones

Additional information

F_{VL}	171 N	Preload force light
F_{VM}	513 N	Preload force medium
F_{VH}	1.025 N	Preload force heavy
K_{aEL}	508 N	Lift-off force light
K_{aEM}	1.594 N	Lift-off force medium
K_{aEH}	3.313 N	Lift-off force heavy
c_{aL}	80,8 N/ μ m	Axial rigidity light
c_{aM}	126 N/ μ m	Axial rigidity medium
c_{aH}	171 N/ μ m	Axial rigidity heavy