

FAG

HS7003-E-T-P4S-UL

Angular contact ball bearing

Schaeffler ID:
0380446250000Spindle bearings HS70..-E, adjusted,
in pairs or sets, contact angle $\alpha = 25^\circ$,
restricted tolerances

Technical information

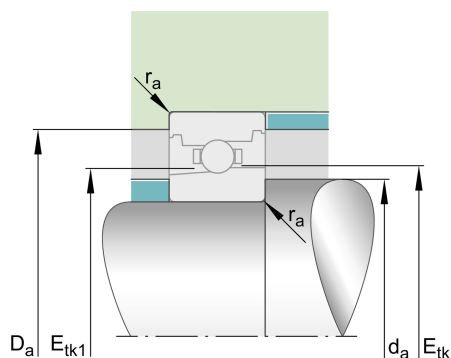
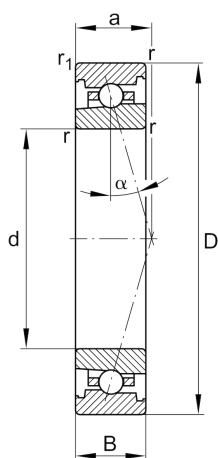
**Temperature range**

T_{min}	-30 °C	Operating temperature min.
T_{max}	100 °C	Operating temperature max.
	40 g	Weight

Main Dimensions & Performance Data

d	17 mm	Bore diameter
D	35 mm	Outside diameter
B	10 mm	Width
C_r	3.350 N	Basic dynamic load rating, radial
C_{0r}	1.520 N	Basic static load rating, radial
C_{ur}	161 N	Fatigue load limit, radial
$n_{G Grease}$	56.000 1/min	Limiting speed for grease lubrication
$n_{G Oil}$	85.000 1/min	Limiting speed for oil lubrication

Dimensions

r_{min}	0,3 mm	Minimum chamfer dimension
$r_{1 min}$	0,3 mm	Minimum chamfer dimension
α	25 °	Contact angle



Mounting dimensions

d_a	21 mm	Diameter shaft shoulder
d_a	h12	Diameter shaft shoulder clearance
D_a	32 mm	Shoulder diameter outer ring
D_a	H12	Shoulder diameter outer ring clearance
$r_{a \max}$	0,3 mm	Maximum recess radius
$r_{a1 \max}$	0,1 mm	Maximum recess radius
$E_{tk \min}$	24,1 mm	Minimum diameter injection pitch
$E_{tk \max}$	24,8 mm	Maximum diameter injection pitch
$E_{tk1 \min}$	22,9 mm	Minimum diameter injection pitch
$E_{tk1 \max}$	24,8 mm	Maximum diameter injection pitch
a	11,1 mm	Distance between the apexes of the pressure cones

Additional information

F_{VL}	21 N	Preload force light
F_{VM}	63 N	Preload force medium
F_{VH}	126 N	Preload force heavy
K_{aEL}	61 N	Lift-off force light
K_{aEM}	187 N	Lift-off force medium
K_{aEH}	382 N	Lift-off force heavy
c_{aL}	35,7 N/ μm	Axial rigidity light
c_{aM}	53,4 N/ μm	Axial rigidity medium
c_{aH}	70 N/ μm	Axial rigidity heavy