

FAG

**HS7004-E-T-P4S-UL**

Angular contact ball bearing

Schaeffler ID:  
0384406790000Spindle bearings HS70..-E, adjusted,  
in pairs or sets, contact angle  $\alpha = 25^\circ$ ,  
restricted tolerances

## Technical information

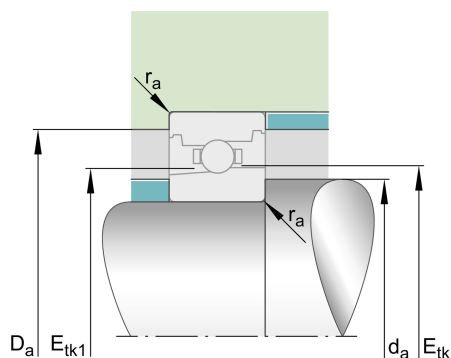
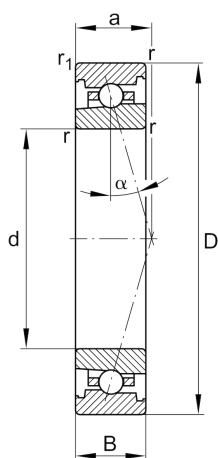
**Temperature range**

$T_{\min}$	-30 °C	Operating temperature min.
$T_{\max}$	100 °C	Operating temperature max.
	80 g	Weight

**Main Dimensions & Performance Data**

d	20 mm	Bore diameter
D	42 mm	Outside diameter
B	12 mm	Width
$C_r$	5.400 N	Basic dynamic load rating, radial
$C_{0r}$	2.600 N	Basic static load rating, radial
$C_{ur}$	275 N	Fatigue load limit, radial
$n_{G \text{ Grease}}$	48.000 1/min	Limiting speed for grease lubrication
$n_{G \text{ Oil}}$	75.000 1/min	Limiting speed for oil lubrication

**Dimensions**

$r_{\min}$	0,6 mm	Minimum chamfer dimension
$r_{1 \min}$	0,6 mm	Minimum chamfer dimension
$\alpha$	25 °	Contact angle

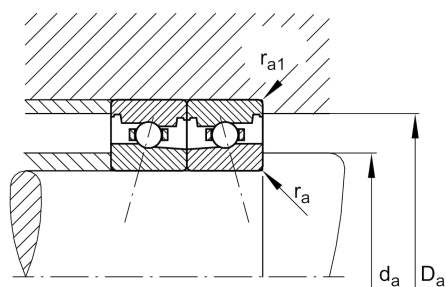

### Mounting dimensions

$d_a$	25 mm	Diameter shaft shoulder
$d_a$	h12	Diameter shaft shoulder clearance
$D_a$	37 mm	Shoulder diameter outer ring
$D_a$	H12	Shoulder diameter outer ring clearance
$r_{a \max}$	0,6 mm	Maximum recess radius
$r_{a1 \max}$	0,3 mm	Maximum recess radius
$E_{tk \min}$	28,6 mm	Minimum diameter injection pitch
$E_{tk \max}$	29,7 mm	Maximum diameter injection pitch
$E_{tk1 \min}$	27,1 mm	Minimum diameter injection pitch
$E_{tk1 \max}$	29,7 mm	Maximum diameter injection pitch
$a$	13,2 mm	Distance between the apexes of the pressure cones

### Additional information

$F_{VL}$	34 N	Preload force light
$F_{VM}$	101 N	Preload force medium
$F_{VH}$	202 N	Preload force heavy
$K_{aEL}$	97 N	Lift-off force light
$K_{aEM}$	299 N	Lift-off force medium
$K_{aEH}$	611 N	Lift-off force heavy
$c_{aL}$	49,1 N/ $\mu\text{m}$	Axial rigidity light
$c_{aM}$	73,6 N/ $\mu\text{m}$	Axial rigidity medium
$c_{aH}$	96,4 N/ $\mu\text{m}$	Axial rigidity heavy