

FAG

HS7005-E-T-P4S-UL

Angular contact ball bearing

Schaeffler ID:
0191840340000Spindle bearings HS70..-E, adjusted,
in pairs or sets, contact angle $\alpha = 25^\circ$,
restricted tolerances

Technical information

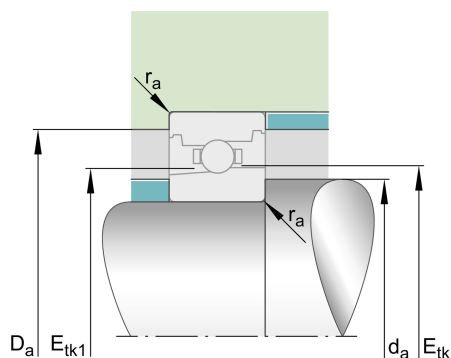
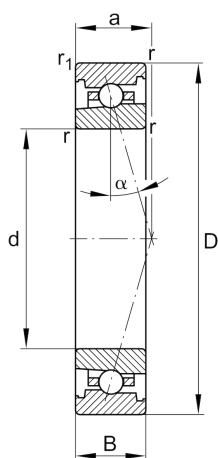
**Temperature range**

T_{min}	-30 °C	Operating temperature min.
T_{max}	100 °C	Operating temperature max.
	0,09 kg	Weight

Main Dimensions & Performance Data

d	25 mm	Bore diameter
D	47 mm	Outside diameter
B	12 mm	Width
C_r	5.500 N	Basic dynamic load rating, radial
C_{0r}	2.800 N	Basic static load rating, radial
C_{ur}	295 N	Fatigue load limit, radial
$n_{G Grease}$	40.000 1/min	Limiting speed for grease lubrication
$n_{G Oil}$	63.000 1/min	Limiting speed for oil lubrication

Dimensions

r_{min}	0,6 mm	Minimum chamfer dimension
$r_{1 min}$	0,6 mm	Minimum chamfer dimension
α	25 °	Contact angle

Mounting dimensions

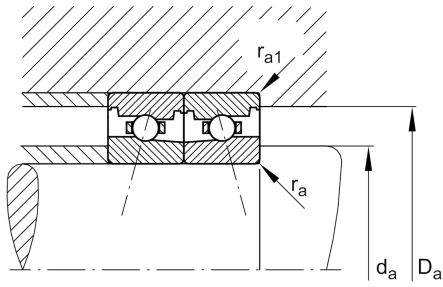

d_a	30 mm	Diameter shaft shoulder
d_a	h12	Diameter shaft shoulder clearance
D_a	42 mm	Shoulder diameter outer ring
D_a	H12	Shoulder diameter outer ring clearance
$r_{a \max}$	0,6 mm	Maximum recess radius
$r_{a1 \max}$	0,3 mm	Maximum recess radius
$E_{tk \min}$	33,6 mm	Minimum diameter injection pitch
$E_{tk \max}$	34,5 mm	Maximum diameter injection pitch
$E_{tk1 \min}$	32,2 mm	Minimum diameter injection pitch
$E_{tk1 \max}$	34,5 mm	Maximum diameter injection pitch
a	14,4 mm	Distance between the apexes of the pressure cones

Additional information

F_{VL}	35 N	Preload force light
F_{VM}	104 N	Preload force medium
F_{VH}	207 N	Preload force heavy
K_{aEL}	100 N	Lift-off force light
K_{aEM}	306 N	Lift-off force medium
K_{aEH}	626 N	Lift-off force heavy
c_{aL}	51,2 N/ μm	Axial rigidity light
c_{aM}	76,7 N/ μm	Axial rigidity medium
c_{aH}	100 N/ μm	Axial rigidity heavy